

**INDOOR AIR QUALITY ASSESSMENT REPORT  
JUNE 8, 2016, EVENT  
GLENWOOD MIDDLE SCHOOL  
2680 ROUTE 97  
GLENWOOD, MARYLAND 21738**

**PREPARED FOR**

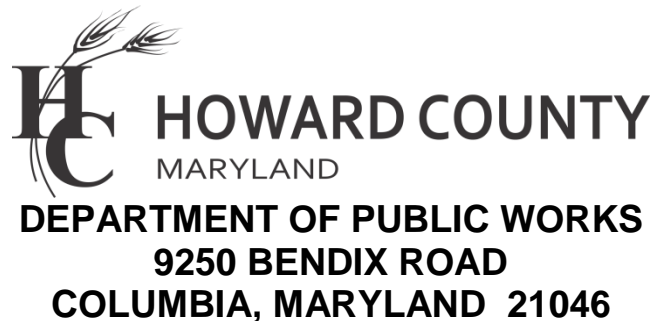

**PREPARED BY**



**449 EISENHOWER BOULEVARD, SUITE 300  
HARRISBURG, PENNSYLVANIA 17111**

**AUGUST 1, 2016**

# TABLE OF CONTENTS

	<b>PAGE</b>
1.0 EXECUTIVE SUMMARY .....	1
2.0 BACKGROUND.....	2
3.0 OBSERVATIONS AND MEASUREMENTS.....	3
3.1 VISUAL INSPECTION .....	3
3.2 COMFORT PARAMETERS, CARBON MONOXIDE, AND PARTICULATES ....	4
3.2.1 Assessment Methodology .....	4
3.2.2 Assessment Findings .....	5
3.3 FUNGI .....	8
3.3.1 Assessment Methodology .....	8
3.3.2 Assessment Findings .....	10
4.0 REFERENCES.....	14
5.0 LIMITATIONS AND USER RELIANCE.....	15

## APPENDICES

APPENDIX A – BUILDING FLOOR PLANS

APPENDIX B – SPORE TRAP SAMPLE ANALYTICAL REPORT, CHAIN OF CUSTODY, AND LABORATORY ACCREDITATION

APPENDIX C – INSTRUMENT CALIBRATION LOGS

## LIST OF TABLES

NO.	DESCRIPTION	PAGE
1	ACCEPTABLE RANGES OF TEMPERATURE AND RELATIVE HUMIDITY IN SUMMER AND WINTER .....	4
2A	CARBON DIOXIDE, TEMPERATURE, RELATIVE HUMIDITY, CARBON MONOXIDE, AND PARTICULATES MEASUREMENTS ASSOCIATED WITH OUTSIDE/EXTERIOR SAMPLE 1 LOCATION JUNE 8, 2016, SAMPLING EVENT .....	6
2B	CARBON DIOXIDE, TEMPERATURE, RELATIVE HUMIDITY, CARBON MONOXIDE, AND PARTICULATES MEASUREMENTS ASSOCIATED WITH OUTSIDE/EXTERIOR SAMPLE 2 LOCATION JUNE 8, 2016, SAMPLING EVENT .....	7
2C	CARBON DIOXIDE, TEMPERATURE, RELATIVE HUMIDITY, CARBON MONOXIDE, AND PARTICULATES MEASUREMENTS ASSOCIATED WITH OUTSIDE/EXTERIOR SAMPLE 3 LOCATION JUNE 8, 2016, SAMPLING EVENT .....	7
2D	CARBON DIOXIDE, TEMPERATURE, RELATIVE HUMIDITY, CARBON MONOXIDE, AND PARTICULATES MEASUREMENTS ASSOCIATED WITH OUTSIDE/EXTERIOR SAMPLE 4 LOCATION JUNE 8, 2016, SAMPLING EVENT .....	8
3A	SUMMARY OF SPORE TRAP SAMPLE ANALYTICAL RESULTS ASSOCIATED WITH OUTSIDE/EXTERIOR SAMPLE 1 LOCATION JUNE 8, 2016, SAMPLING EVENT .....	11
3B	SUMMARY OF SPORE TRAP SAMPLE ANALYTICAL RESULTS ASSOCIATED WITH OUTSIDE/EXTERIOR SAMPLE 2 LOCATION JUNE 8, 2016, SAMPLING EVENT .....	12
3C	SUMMARY OF SPORE TRAP SAMPLE ANALYTICAL RESULTS ASSOCIATED WITH OUTSIDE/EXTERIOR SAMPLE 3 LOCATION JUNE 8, 2016, SAMPLING EVENT .....	12
3D	SUMMARY OF SPORE TRAP SAMPLE ANALYTICAL RESULTS ASSOCIATED WITH OUTSIDE/EXTERIOR SAMPLE 4 LOCATION JUNE 8, 2016, SAMPLING EVENT .....	13



## **1.0 EXECUTIVE SUMMARY**

## 1.0 EXECUTIVE SUMMARY

The Howard County Department of Public Works retained Skelly and Loy, Inc. to conduct an Indoor Air Quality (IAQ) assessment of Glenwood Middle School within Howard County, Maryland. The assessment occurred on June 8, 2016.

The Scope of Work for these assessments included the collection of air samples for subsequent spore trap analysis and measuring various IAQ parameters as follows:

1. Comfort parameters (carbon dioxide [CO<sub>2</sub>], temperature, and relative humidity);
2. Carbon monoxide (CO); and
3. Particulates – Total Particulate Matter 10 microns in diameter and smaller (PM<sub>10</sub>).
4. Total airborne fungi;

Additionally, select accessible portions of the school were to be visually inspected, looking for signs of past or ongoing water damage and mold growth.

Regarding the airborne fungal spore trap sampling, one or more Genera of fungal spores was identified in six different occupied areas within the school.

Regarding the measurement of CO<sub>2</sub>, temperature, relative humidity, CO, and particulates measured on June 8, all parameters measured fell within acceptable ranges except for relative humidity levels which were below the lower limit of 30% in ten areas assessed.

Regarding the visual inspection performed, it appeared that recent drywall replacement work occurred in Portable Classroom 61 next to the door. The custodian accompanying the sampling technicians from Skelly and Loy and Aria Environmental reported that mold in the wall of Portable Classroom 61 was identified by others, and the drywall was subsequently replaced. The visual observations appear to support the custodian's report.

## **2.0 BACKGROUND**

## 2.0 BACKGROUND

Skelly and Loy, Inc. was retained by the Howard County Department of Public Works to perform IAQ assessments at various elementary, middle, and high schools within the Howard County Public School System. Assessment efforts included the following:

- a visual inspection of accessible portions of the school;
- the measurement and recordation of comfort parameters, including CO<sub>2</sub>, temperature, and relative humidity;
- the measurement and recordation of airborne CO and particulates; and
- the collection and analysis of fungal spore trap samples.

Including outdoor/exterior control (or baseline) locations, a total of 20 locations were assessed. This report is for the assessment performed at Glenwood Middle School on June 8, 2016.

Glenwood Middle School is one of 20 middle schools located in Howard County, Maryland, and serves students in grades 6 through 8. It is located at 2680 Route 97 in Glenwood, Maryland, 21738. Enrollment in school year 2015-2016 is reported to be 561. The school capacity is reported to be 545, but this does not include the additional capacity provided by six portable classrooms. This school first opened in 1967 and had renovations in 1986, 1999, 2000, and 2010.

A copy of the school's floor plans is included in Appendix A.

## **3.0 OBSERVATIONS AND MEASUREMENTS**

### 3.0 OBSERVATIONS AND MEASUREMENTS

Assessment locations within the school were selected with a number of factors being considered:

- At least one assessment location should occur within each of the buildings' heating, ventilation, and air conditioning (HVAC) zones.
- Assessment locations should be evenly dispersed geographically throughout the school.
- If the school has portable classrooms, all such portable classrooms are to be assessed.

The locations where all 20 assessments occurred are depicted on the floor plans in Appendix A. The locations, dimensions, and orientation of all portable classrooms presented on the floor plans are approximate only. The floor plans depicting the assessment locations (Appendix A) were generated from base floor plans/heating, ventilation, and air conditioning zone plans obtained from Howard County Public Schools. On the floor plans in Appendix A and in Tables 2A, 2B, 2C, 2D, 3A, 3B, 3C, and 3D, the various interior sampling and assessment locations that were compared against specific outside/exterior "control" locations are identified by color (on the floor plans in Appendix A) and by grouping (in Tables 2A, 2B, 2C, 2D, 3A, 3B, 3C, and 3D).

#### 3.1 VISUAL INSPECTION

During the on-site assessment activities, the industrial hygienist technician looked for signs of past and/or ongoing water infiltration, leaks, and damage to interior building materials, including signs of past or ongoing mold growth. Additionally, where applicable, if any building occupants (teachers and/or custodial staff) offered any information regarding IAQ concerns, water damage, or mold growth, the technician also recorded this information.

Regarding the visual inspection portion of the assessment, it appeared that recent drywall replacement work occurred in Portable Classroom 61 next to the door. The custodian accompanying the technician reported that mold in the wall of Portable Classroom 61 was identified by others and portions of the wall were subsequently replaced.

## 3.2 COMFORT PARAMETERS, CARBON MONOXIDE, AND PARTICULATES

### 3.2.1 Assessment Methodology

Measurements of CO<sub>2</sub>, air temperature, relative humidity, and CO concentrations were made using a calibrated direct reading hand-held TSI brand Q- Trak Model 7575 (or equivalent) instrument. Measurements of particulate concentrations were made using a TSI Brand Dust Trak II (or equivalent) particulate monitor. These instruments provide quick, accurate information to assess key IAQ parameters. The meters were allowed to equilibrate at each sample location prior to recording the measurements. Copies of the calibration records/certificates for the Q- and Dust Track meters are included in Appendix C.

American Society of Heating, Refrigerating and Air Conditioning Engineers (ASHRAE) 55-2010, "Thermal Environmental Conditions for Human Occupancy" provides guidance for the desirable ranges of temperature and relative humidity to achieve occupant comfort. That document recommends that indoor air temperatures generally be maintained between 68 degrees Fahrenheit (°F) and 74 °F in the winter and 73 °F and 79 °F in the summer for 80 percent (%) occupant acceptability.<sup>1</sup> These ranges are presented in Table 1.

**TABLE 1  
ACCEPTABLE RANGES OF TEMPERATURE AND RELATIVE HUMIDITY  
IN SUMMER AND WINTER\***

<b>RELATIVE HUMIDIFY</b>	<b>WINTER TEMPERATURE</b>	<b>SUMMER TEMPERATURE</b>
30%	68.5 °F - 76.0 °F	74.0 °F - 80.0 °F
40%	68.5 °F - 75.5 °F	73.5 °F - 79.5 °F
50%	68.5 °F - 74.5 °F	73.0 °F - 79.0 °F
60%	68.0 °F - 74.0 °F	72.5 °F - 78.0 °F

\* Adapted from ASHRAE Standard 55-2013

There are currently no specific Health and Safety regulations for relative humidity in indoor air. However, ASHRAE Standard 62.1-2010, "Ventilation for Acceptable Indoor Air Quality," recommends that relative humidity levels be maintained below 65% with a relative

humidity of 50% being ideal.<sup>2</sup> U.S. Environmental Protection Agency (U.S. EPA) Tools for Schools recommends that relative humidity levels be maintained between 30% and 60%.<sup>3</sup>

ASHRAE Standard 62.1-2010, "Ventilation for Acceptable Indoor Air Quality," specifies fresh air requirements for various types of occupancies. IAQ studies performed by the National Institute for Occupational Safety and Health (NIOSH) have indicated that, by far, the most common contributor to IAQ complaints is inadequate ventilation. CO<sub>2</sub> is often utilized as an indicator of fresh air infusion into buildings. CO<sub>2</sub> is a normal component of the atmosphere and is typically present at concentrations between 300 and 500 parts per million (ppm) in outside air. Because humans produce CO<sub>2</sub>, its build-up in an occupied space may be an indicator of inadequate fresh air supply. For occupant comfort, ASHRAE recommends that CO<sub>2</sub> concentration in a space be maintained no greater than 700 ppm above outdoor air levels.<sup>2</sup>

The U.S. EPA National Ambient Air Quality Primary Standard for CO is 9 ppm for an eight-hour period that is not to be exceeded more than once per year. There is also a 35 ppm level for a one-hour period that is not to be exceeded more than once per year.<sup>4</sup> CO is formed from incomplete oxidation during combustion of natural gas and other fuels.

Total particulate levels were measured using a direct reading, factory calibrated TSI brand DustTrak II IAQ (or equivalent) instrument. This instrument measures particulates 10 microns and smaller also referred to as PM<sub>10</sub>.

The U.S. Occupational Safety and Health Administration (OSHA) Permissible Exposure Limit (PEL) for inert airborne particulates (not otherwise regulated) is 15 mg/M<sup>3</sup> of air as a total particulate sample or 5 mg/M<sup>3</sup> of air as a respirable particulate sample.<sup>7</sup> In 1987, the U.S. EPA replaced the earlier Total Suspended Particulate (TSP) air quality standard with a PM<sub>10</sub> standard. The newer standard focuses on smaller particles that are likely responsible for adverse health effects because of their ability to reach the lower regions of the respiratory tract. The PM<sub>10</sub> standard includes particles with a diameter of 10 micrometers or less (i.e., 0.0004 inch or one-seventh the width of a human hair). The U.S. EPA's health-based national air quality standard for PM<sub>10</sub> is 0.15 mg/M<sup>3</sup> (measured as a daily concentration over a 24-hour period).<sup>7</sup>

### **3.2.2 Assessment Findings**

Regarding the measurement of CO<sub>2</sub>, temperature, relative humidity, CO, and particulates, the bolded measurements in Tables 2A, 2B, 2C, and 2D (pages 6-8) fell outside of their corresponding acceptable range. All parameters measured were acceptable except for relative

humidity levels, which were below the lower limit of 30% in ten areas assessed. Many of these ten measurements were only slightly below 30%, and two measurements were in non-classroom areas (kitchen and boy's locker room) where relative humidity levels below 30% are likely preferable.

The comfort parameters associated with Outside/Exterior Sample 1 location are provided in Table 2A, the comfort parameters associated with Outside/Exterior Sample 2 location are provided in Table 2B, the comfort parameters associated with Outside/Exterior Sample 3 location are provided in Table 2C, and the comfort parameters associated with Outside/Exterior Sample 4 location are provided in Table 2D.

**TABLE 2A  
GLENWOOD MIDDLE SCHOOL  
CARBON DIOXIDE, TEMPERATURE, RELATIVE HUMIDITY,  
CARBON MONOXIDE, AND PARTICULATES MEASUREMENTS  
ASSOCIATED WITH OUTSIDE/EXTERIOR SAMPLE 1 LOCATION  
JUNE 8, 2016, SAMPLING EVENT**

<b>SAMPLE/ ASSESSMENT LOCATION</b>	<b>TIME SAMPLED/ ASSESSED</b>	<b>NUMBER OF OCCUPANTS</b>	<b>CO<sub>2</sub> (ppm)</b>	<b>TEMP (°F)</b>	<b>% RELATIVE HUMIDITY</b>	<b>CO (ppm)</b>	<b>PARTICULATES (mg/M<sup>3</sup>)</b>
Out 1	16:33	0	400	68.8	29.2%	0	0.0014
Classroom 60	16:46	0	410	78.1	<b>22.9%</b>	0	0.013
Classroom 61	16:51	0	435	75.3	<b>26.8%</b>	0	0.014
Classroom 70	16:59	0	735	75.1	32.0%	0	0.008
Classroom 71	17:05	0	700	74.2	<b>26.7%</b>	0	0.013
Classroom 80	16:17	0	422	74.3	30.3%	0	0.007
Classroom 81	16:19	0	603	76.8	<b>29.7%</b>	0	0.0012

**Bolded** values indicate the assessed parameter value fell outside of the range deemed acceptable.  
 Acceptable CO<sub>2</sub> range is the background CO<sub>2</sub> level plus 700 ppm.  
 Acceptable temperature range is 73 °F to 79 °F.  
 Acceptable relative humidity range is 30% to 60%.  
 Acceptable CO range is 0 to 9 ppm.  
 Acceptable particulates range is 0 to 0.15 mg/M<sup>3</sup>.



**TABLE 2B  
GLENWOOD MIDDLE SCHOOL  
CARBON DIOXIDE, TEMPERATURE, RELATIVE HUMIDITY,  
CARBON MONOXIDE, AND PARTICULATES MEASUREMENTS  
ASSOCIATED WITH OUTSIDE/EXTERIOR SAMPLE 2 LOCATION  
JUNE 8, 2016, SAMPLING EVENT**

<b>SAMPLE/ ASSESSMENT LOCATION</b>	<b>TIME SAMPLED/ ASSESSED</b>	<b>NUMBER OF OCCUPANTS</b>	<b>CO<sub>2</sub> (ppm)</b>	<b>TEMP (°F)</b>	<b>% RELATIVE HUMIDITY</b>	<b>CO (ppm)</b>	<b>PARTICULATES (mg/M<sup>3</sup>)</b>
Out 2 CY	16:35	0	390	78.2	20.3%	0	0.020
Classroom 3	15:16	0	576	75.6	<b>26.0%</b>	0	0.005
Classroom 4	15:18	0	610	74.8	<b>27.1%</b>	0	0.004
Classroom 19	15:31	0	470	76.5	<b>27.1%</b>	0	0.008
Classroom 20	15:32	0	451	74.8	<b>29.0%</b>	0	0.005
Classroom 27	15:46	0	428	75.2	30.8%	0	0.005
Classroom 28	15:47	0	444	74.3	32.2%	0	0.006

**Bolded** values indicate the assessed parameter value fell outside of the range deemed acceptable.  
 Acceptable CO<sub>2</sub> range is the background CO<sub>2</sub> level plus 700 ppm.  
 Acceptable temperature range is 73 °F to 79 °F.  
 Acceptable relative humidity range is 30% to 60%.  
 Acceptable CO range is 0 to 9 ppm.  
 Acceptable particulates range is 0 to 0.15 mg/M<sup>3</sup>.

**TABLE 2C  
GLENWOOD MIDDLE SCHOOL  
CARBON DIOXIDE, TEMPERATURE, RELATIVE HUMIDITY,  
CARBON MONOXIDE, AND PARTICULATES MEASUREMENTS  
ASSOCIATED WITH OUTSIDE/EXTERIOR SAMPLE 3 LOCATION  
JUNE 8, 2016, SAMPLING EVENT**

<b>SAMPLE/ ASSESSMENT LOCATION</b>	<b>TIME SAMPLED/ ASSESSED</b>	<b>NUMBER OF OCCUPANTS</b>	<b>CO<sub>2</sub> (ppm)</b>	<b>TEMP (°F)</b>	<b>% RELATIVE HUMIDITY</b>	<b>CO (ppm)</b>	<b>PARTICULATES (mg/M<sup>3</sup>)</b>
Outside 3	17:31	0	400	71.1	22.3%	0	0.011
Classroom 34	16:00	0	442	76.0	30.3%	0	0.006
Classroom 35	16:01	0	460	75.5	31.8%	0	0.009

**Bolded** values indicate the assessed parameter value fell outside of the range deemed acceptable.  
 Acceptable CO<sub>2</sub> range is the background CO<sub>2</sub> level plus 700 ppm.  
 Acceptable temperature range is 73 °F to 79 °F.  
 Acceptable relative humidity range is 30% to 60%.  
 Acceptable CO range is 0 to 9 ppm.  
 Acceptable particulates range is 0 to 0.15 mg/M<sup>3</sup>.



**TABLE 2D  
 GLENWOOD MIDDLE SCHOOL  
 CARBON DIOXIDE, TEMPERATURE, RELATIVE HUMIDITY,  
 CARBON MONOXIDE, AND PARTICULATES MEASUREMENTS  
 ASSOCIATED WITH OUTSIDE/EXTERIOR SAMPLE 4 LOCATION  
 JUNE 8, 2016, SAMPLING EVENT**

<b>SAMPLE/ ASSESSMENT LOCATION</b>	<b>TIME SAMPLED/ ASSESSED</b>	<b>NUMBER OF OCCUPANTS</b>	<b>CO<sub>2</sub> (ppm)</b>	<b>TEMP (°F)</b>	<b>% RELATIVE HUMIDITY</b>	<b>CO (ppm)</b>	<b>PARTICULATES (mg/M<sup>3</sup>)</b>
Outside 4	17:38	0	415	72.8	23.4%	0	0.011
Boys Locker Room (50)	17:18	0	445	75.1	<b>23.3%</b>	0	0.004
Kitchen (57)	17:15	0	460	75.3	<b>26.7%</b>	0	0.019

**Bolded** values indicate the assessed parameter value fell outside of the range deemed acceptable.  
 Acceptable CO<sub>2</sub> range is the background CO<sub>2</sub> level plus 700 ppm.  
 Acceptable temperature range is 73 °F to 79 °F.  
 Acceptable relative humidity range is 30% to 60%.  
 Acceptable CO range is 0 to 9 ppm.  
 Acceptable particulates range is 0 to 0.15 mg/M<sup>3</sup>.

### 3.3 FUNGI

#### 3.3.1 Assessment Methodology

Fungi are common in and found throughout both the natural and man-made environment. Airborne mold is commonly found in homes, hotels, businesses, and offices, and in institutional and commercial buildings. It is quite possible that there are higher levels of fungi in one's home than in one's school or work. Many airborne fungi identified in the man-made environment (i.e., inside of buildings) originate outdoors and are brought inside with fresh air and attached to items brought into the buildings, including its occupants.

However, for certain sensitive individuals, increased levels of certain airborne fungi can cause adverse reactions. All individuals react differently to exposure to fungi, and the degree of reaction can change with time. Additionally, the degree of reaction can be affected by other factors, including an individual's overall health, the length and frequency of exposure, and other contaminants to which an individual is exposed. Also, individuals' susceptibility to different mold Genera, or combinations of mold Genera, vary. Because of this, there are no established regulatory or health-based levels of fungi above which could lead to moderate or severe illnesses. For fungi to grow, three criteria must be met: the presence of fungal spores, a food source, and



moisture. Any organic matter can serve as the food source, and moisture can be from liquid water or elevated humidity. If any of these three criteria are eliminated, fungal growth will not occur.

Total airborne fungi samples were collected on specialized spore trap cassettes using a calibrated specialty sampling pump flowing at 15 liters of air per minute (lpm) for a total of 10 minutes and a total sample volume of 150 liters. Sampling works on the principle of initial impaction. Presumably particulate-laden air is drawn through the cassette's tapered inlet and accelerates the stream against a small slide coated with a collection media (adhesive). This sampling method is one that is industry-accepted.<sup>5</sup> The pump pulls air through the spore trap cassette before the air is subsequently pulled through the pump, so there is no need to decontaminate the pump between samples. Following the assessment, the spore trap samples were shipped under proper chain of custody (COC) to Southeast Environmental Microbiology Laboratories in Greenville, South Carolina, for microscopic count and identification (i.e., Genus) of fungi. Copies of the COC and corresponding results are included as Appendix B along with the laboratory's accreditation. All spore trap sample results were reported in fungal spores per cubic meter of air (spores/m<sup>3</sup>) for the purposes of this assessment. The sampling pump used to collect the spore trap samples was calibrated using a manufacturer-supplied rotometer both before and after the sampling event. A copy of the calibration log is included as Appendix C. Specific areas of the school that were assessed and sampled are identified on the COC (Appendix B) and in Tables 3A and 3B (pages 11 and 12); these can be ascertained by cross-referencing the referenced room numbers to the room numbers on the floor plans (Appendix A).

There are currently no state or federal Health and Safety regulations or universally accepted guidelines for exposure to fungal spores in indoor air. The American Conference of Governmental Industrial Hygienists (ACGIH) has taken the position that the development of exposure guidelines based on the enumeration of viable or total (i.e., both viable and nonviable) fungi in air is not feasible.<sup>6</sup> It is commonly accepted that a "one size fits all" approach to developing exposure guidelines will not work due to wide variations in how different individuals respond to exposure to airborne fungi. To further complicate the development of exposure guidelines, multiple agencies and organizations have (sometimes widely) varying opinions on how exposure guidelines should be set and what the guidelines should be.

Because there are no "absolute" exposure limits for airborne fungal spores, the assessment protocol called for the comparison of indoor results from the interior areas with results from the outdoor air. In an ideal situation, indoor results should show lower fungi counts than outdoor

samples and contain similar biodiversity. The results of the visual inspection and the building's history related to moisture and ventilation must also be considered when interpreting fungal air sample results. For the June 8 event, Outside/Exterior Sample 1 is being compared to Traditional Classrooms 60, 61, 70, 71, 80, and 81. Outside/Exterior Sample 2 is being compared to results from Traditional Classrooms 3, 4, 19, 20, 27, and 28. Outside/Exterior Sample 3 is being compared to results from Traditional Classrooms 34 and 35. Outside/Exterior Sample 4 is being compared to results from the boys locker room (Room 50) and the kitchen (Room (57)).

The locations for the baseline (i.e., Outside/Exterior) assessments were selected based on one outside/exterior sample located in close proximity to the portable classrooms being compared to the results of the portable classroom samples; a second outside/exterior sample being compared to Traditional Classrooms 3, 4, 19, 20, 27, and 28; a third outside/exterior sample being compared against Traditional Classrooms 34 and 35; and a fourth outside/exterior sample being compared against the boys locker room (50) and kitchen (57).

### 3.3.2 Assessment Findings

Regarding the sampling and analysis for airborne fungal spores, some locations had one or more mold Genera identified at a concentration in excess of its corresponding outside/exterior concentration. When viewing Tables 3A, 3B, 3C, and 3D, bolded values represent such occurrences. Values in Tables 3A, 3B, 3C, and 3D that are **bolded black** indicate that an interior mold source is likely, although airborne concentrations appear to be marginal. Values that are **bolded red** also indicate that an interior mold source is likely and that airborne concentrations appear to be higher than expected for a healthy indoor environment.<sup>5</sup>

When determining airborne fungi values that are marginal versus values that are higher than expected based on industry accepted practice, it must be noted that some limitations exist. The 1.5 multiplier was selected based on its reasonableness in helping identify those molds identified inside at a concentration higher than outside, while leaving some leeway for an occasional outlying value that was not considerably higher. Relatively low concentrations could still be bolded red if the corresponding exterior baseline concentrations were 1.5 times less or zero. It should be kept in mind that when calculating the airborne mold spore concentration, the laboratory uses a factor of 7 when multiplying the actual raw spore count (i.e., the actual number of a particular mold spore seen with a microscope by the analyst) to derive the concen-

tration in spores per cubic meter of air. Therefore many bolded red values of low concentration may still be higher than ideal but are not necessarily uncommon or of concern.

**TABLE 3A  
GLENWOOD MIDDLE SCHOOL  
SUMMARY OF SPORE TRAP SAMPLE ANALYTICAL RESULTS  
ASSOCIATED WITH OUTSIDE/EXTERIOR SAMPLE 1 LOCATION  
JUNE 8, 2016, SAMPLING EVENT**

LOCATION	ALTERNARIA	ASCOSPORES	BASIDIOSPORES	BIPOLARIS/ DRECHSLERA	CHAETOMIUM	CLADOSPORIUM	CURVULARIA	EPICOCCUM	NIGROSPORA	PENICILLIUM/ ASPERGILLUS	POLYTHRINCIUM	RUSTS	SMUTS/PERICONIA/ MYXOMY	TORULA	PITHOMYCES
	(spores/m <sup>3</sup> )														
Out 1	21	203				714		21					77	7	
Classroom 60	<b>70</b>	168	<b>105</b>	7		189	7	<b>168</b>		<b>315</b>		<b>7</b>	<b>91</b>		
Classroom 61		42	<b>42</b>			189		14							
Classroom 70	7	147	<b>147</b>			294				<b>42</b>			49		
Classroom 71		7	<b>63</b>			84		7		<b>42</b>			14		
Classroom 80		<b>210</b>	<b>168</b>			441				<b>84</b>			14		
Classroom 81	7	<b>210</b>	<b>231</b>			588		<b>49</b>		<b>21</b>			14		

**Bold Black** values are indicative of a mold source within the building and levels appear to be marginal. There are no established state or federal guidelines for determining levels that pose a health risk to the general population.

**Bold Red** values are indicative of a mold source within the building and levels appear to be higher than expected based on industry-accepted practices. Nonetheless, there are no established state or federal guidelines for determining levels that pose a health risk to the general population.

**TABLE 3B  
GLENWOOD MIDDLE SCHOOL  
SUMMARY OF SPORE TRAP SAMPLE ANALYTICAL RESULTS  
ASSOCIATED WITH OUTSIDE/EXTERIOR SAMPLE 2 LOCATION  
JUNE 8, 2016, SAMPLING EVENT**

LOCATION	ALTERNARIA	ASCOSPORES	BASIDIOSPORES	BIPOLARIS/ DRECHSLERA	CHAETOMIUM	CLADOSPORIUM	CURVULARIA	EPICOCCUM	NIGROSPORA	PENICILLIUM/ ASPERGILLUS	POLYTHRINCIUM	RUSTS	SMUTS/PERICONIA/ MYXOMY	TORULA	PITHOMYCES
	(spores/m <sup>3</sup> )														
Out 2 CY	84	693	378			1740		182			7		63		
Classroom 3			84		<b>7</b>	140		7		<b>28</b>			14		
Classroom 4						84				<b>42</b>			14		
Classroom 19		63	21			105		49		<b>105</b>			7		
Classroom 20			21			168				<b>21</b>					
Classroom 27			84			168				<b>105</b>			7		
Classroom 28		35	21	7		84		7		<b>63</b>					

**Bold Red** values are indicative of a mold source within the building and levels appear to be higher than expected based on industry-accepted practices. Nonetheless, there are no established state or federal guidelines for determining levels that pose a health risk to the general population.

**TABLE 3C  
GLENWOOD MIDDLE SCHOOL  
SUMMARY OF SPORE TRAP SAMPLE ANALYTICAL RESULTS  
ASSOCIATED WITH OUTSIDE/EXTERIOR SAMPLE 3 LOCATION  
JUNE 8, 2016, SAMPLING EVENT**

LOCATION	ALTERNARIA	ASCOSPORES	BASIDIOSPORES	BIPOLARIS/ DRECHSLERA	CHAETOMIUM	CLADOSPORIUM	CURVULARIA	EPICOCCUM	NIGROSPORA	PENICILLIUM/ ASPERGILLUS	POLYTHRINCIUM	RUSTS	SMUTS/PERICONIA/ MYXOMY	TORULA	PITHOMYCES
	(spores/m <sup>3</sup> )														
Outside 3	14	504	483	7		966		105					35		
Classroom 34		28	21			147		7		<b>42</b>			7		
Classroom 35	7	105	84			42		28		<b>168</b>		<b>7</b>			

**Bold Red** values are indicative of a mold source within the building and levels appear to be higher than expected based on industry-accepted practices. Nonetheless, there are no established state or federal guidelines for determining levels that pose a health risk to the general population.



**TABLE 3D  
 GLENWOOD MIDDLE SCHOOL  
 SUMMARY OF SPORE TRAP SAMPLE ANALYTICAL RESULTS  
 ASSOCIATED WITH OUTSIDE/EXTERIOR SAMPLE 4 LOCATION  
 JUNE 8, 2016, SAMPLING EVENT**

LOCATION	ALTERNARIA	ASCOSPORES	BASIDIOSPORES	BIPOLARIS/ DRECHSLERA	CHAETOMIUM	CLADOSPORIUM	CURVULARIA	EPICOCCUM	NIGROSPORA	PENICILLIUM/ ASPERGILLUS	POLYTHRINCIUM	RUSTS	SMUTS/PERICONIA/ MYXOMY	TORULA	PITHOMYCES
	(spores/m <sup>3</sup> )														
Outside 4	42	413	63			882		147	7		7	7	154		
Boys Locker Room (50)		42	<b>84</b>			42									<b>7</b>
Kitchen (57)	14	147				378		14					7		<b>7</b>

**Black** values are indicative of a mold source within the building and levels appear to be marginal. There are no established state or federal guidelines for determining levels that pose a health risk to the general population.

**Red** values are indicative of a mold source within the building and levels appear to be higher than expected based on industry-accepted practices. Nonetheless, there are no established state or federal guidelines for determining levels that pose a health risk to the general population.



## **4.0 REFERENCES**

## 4.0 REFERENCES

1. American Society for Heating, Refrigeration, and Air Conditioning Engineers (ASHRAE), Standard 55-2010, "Thermal Environmental Conditions for Human Occupancy," ASHRAE, Atlanta, Georgia, 2010.
2. American Society for Heating, Refrigeration, and Air Conditioning Engineers (ASHRAE), Standard 62.1-2010, "Ventilation for Acceptable Indoor Air Quality," ASHRAE, Atlanta, Georgia, 2010.
3. United States Environmental Protection Agency (U.S. EPA), Tools for Schools, U.S. EPA 402/K-07/008, January 2009.
4. United States Environmental Protection Agency (U.S. EPA), Clean Air Act – National Ambient Air Quality Standard, 40 CFR Part 50, 1990.
5. Jensen, Paul A., Ph.D., P.E., CIH; and Schafer, Millie P., Ph.D.; NIOSH/DPSE "Sampling and Characterization of Bioaerosols," NIOSH Manual of Analytical Methods, Chapter J, January 15, 1998
6. ACGIH, 2015 Threshold Limit Values and Biological Exposure Indices
7. National Institute for Occupational Safety and Health/Centers for Disease Control, Pocket Guide to Chemical Hazards 2015, Cincinnati, Ohio, 2015.



## **5.0 LIMITATIONS AND USER RELIANCE**

## 5.0 LIMITATIONS AND USER RELIANCE

The scope of this report is limited to the matters expressly covered. In preparing this report, Skelly and Loy has relied, in part, on information derived from secondary sources and interviews. Except as set forth in this report, Skelly and Loy has made no independent investigation as to the accuracy or completeness of the information derived from the secondary sources and interviews and has assumed that such information was accurate and correct. The floor plans depicting the assessment locations (Appendix A) were generated from base floor plans/heating, ventilation, and air conditioning zone plans obtained from Howard County Public Schools. Dimensions, orientation, and locations of any portable classrooms depicted are approximate only.

Skelly and Loy's findings are based on and have been developed in accordance with generally accepted standards of indoor air quality assessments, scientific principles, and professional judgment with resultant subjective interpretations. Professional judgments expressed herein are based on the facts currently available within the limits of existing data, Scope of Work, budget, and schedule. The findings are relevant for the dates of our site visit and should not be relied on to represent conditions at a later date.

This report was completed in accordance with the Scope of Work and contractual agreement between Skelly and Loy and the Howard County Department of Public Works. This report has been prepared for and is intended for the exclusive use of Howard County Department of Public Works, the client, and those parties authorized by the client. The information may not be relied on by any other person or entity without the written authorization of Skelly and Loy or the client.

## **APPENDICES**

**APPENDIX A -  
BUILDING FLOOR PLANS**

**IAQ Assessment Legend**  
**Glenwood Middle School - June 8, 2016, Event**

- X Outside/Exterior Sample 1 Location
- X Outside/Exterior Sample 2 Location
- X Outside/Exterior Sample 3 Location
- X Outside/Exterior Sample 4 Location
- ● ● Spore Trap Sampling IAQ and Parameters Assessment Locations Associated with Outside/Exterior Samples
- Portable Classrooms Associated with Outside/Exterior Samples

Skelly and Loy Project R10-0163.019, Task 1

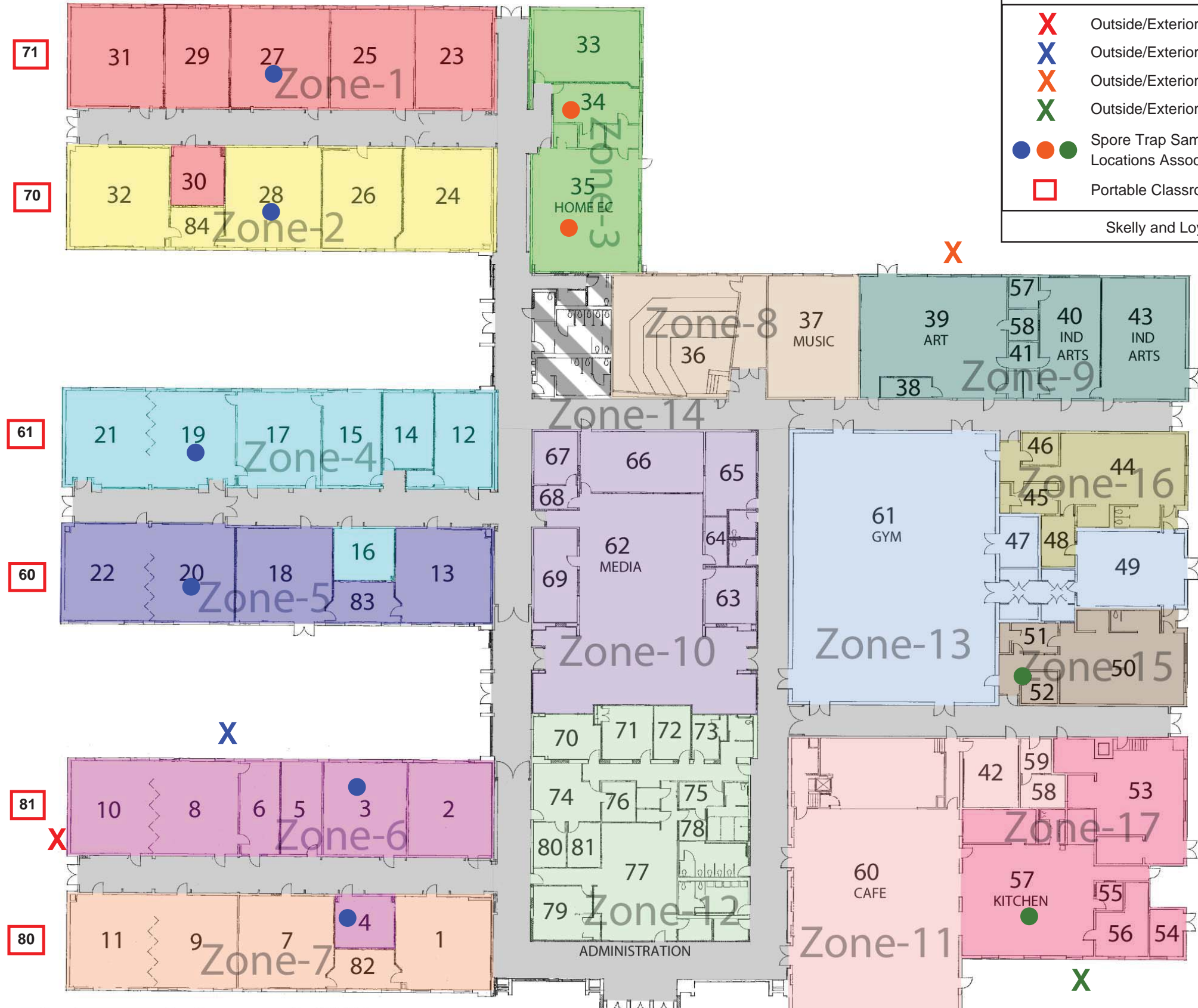

- |         |         |         |         |         |                  |
|---------|---------|---------|---------|---------|------------------|
| Zone-13 | Zone-14 | Zone-15 | Zone-16 | Zone-17 | N/A = Not on EMS |
| Zone-7  | Zone-8  | Zone-9  | Zone-10 | Zone-11 | Zone-12          |
| Zone-1  | Zone-2  | Zone-3  | Zone-4  | Zone-5  | Zone-6           |

The Howard County Public School System  
 10910 Route 108 Ellicott City, Maryland 21042-6198 (410)313-6600



Floor Plan prepared by  
 Howard County Public School System

**GLENWOOD MIDDLE FLOOR PLAN**

**MODIFIED - 7/25/11**



**APPENDIX B -  
SPORE TRAP SAMPLE ANALYTICAL REPORT,  
CHAIN OF CUSTODY, AND  
LABORATORY ACCREDITATION**



SEEML Reference Number:  
160610045

**Southeast Environmental Microbiology Laboratories**

506 Laurens Rd  
Greenville, SC 29607  
Phone: (864) 233-3770  
FAX: (864) 233-6589

The information and data for **Skelly and Loy, Inc.** has been checked for thoroughness and accuracy. The following reports are contained within this document:

- Direct Exam Report
- Spore Trap Report
- Andersen Fungal Report
- Quantitative Direct Exam Report
- Quantitative Fungal Report

Lab Manager Review: Rafael Berrios

Date: 06/10/16

Thank you for using SEEML laboratories. We strive to provide superior quality and service. SEEML laboratories are AIHA (American Industrial Hygiene Association) Environmental Microbiology Accredited laboratory for only fungal analysis Air-Direct Examination (EMLAP # 173667).

The data within this report is reliable to three significant figures. The third significant figure is technically unjustified. In this instance, the third figure is reported as an estimate to facilitate the interpretation by the customer.

**Confidentiality Notice:**

The document(s) contained herein are confidential and privileged information, intended for the exclusive use of the individual or entity named above. If the reader of this message is not the intended recipient, or the employee or agent responsible for delivering it to the intended recipient, you are hereby notified that any dissemination, distribution or copying of the document(s) is strictly prohibited. If you have received this document in error, please immediately notify us by telephone to arrange for its return. Thank you.

**Guidelines for Interpretation:**

No accepted quantitative regulatory standards currently exist by which to assess the health risks related to mold and bacterial exposure. Molds and bacteria have been associated with a variety of health effects and sensitivity varies from person to person.

Several organizations, including: the American Conference of Government Industrial Hygienists (ACGIH); the American Industrial Hygiene Association (AIHA); the Indoor Air Quality Association (IAQA); the United States Environmental Protection Agency (USEPA); the Centers for Disease Control (CDC), as well as the California Department of Health Services (CADHS), have all published guidelines for assessment and interpretation of mold resulting from water intrusion in buildings.

Interpretation of the data and information within this document is left to the company, consultant, and/or persons who conducted the fieldwork.

# Spore Trap Report

	Date Sampled: 06/08/16
Attn: Rob Rowley	Date Received: 06/10/16
Skelly and Loy, Inc	Date Analyzed: 06/10/16
449 Eisenhower Blvd.	Date Reported: 06/10/16
Harrisburg, PA 17111	Date Revised:
	Project Name: Glenwood Middle School
	Project Address: 2680 Route 97
	Project City, State, ZIP: Glenwood, MD.21738
	SEEML Reference #: 160610045

**TEST METHOD: DIRECT MICROSCOPY EXAMINATION AT 400X (100% OF TRACE ANALYZED) SEEML SOP 7**

Client Sample ID	Classroom 3			Classroom 4			Classroom 19		
Location	Middle of Room			Middle of Room			Middle of Room		
Lab Sample ID	160610045-188			160610045-189			160610045-190		
Detection Limit (spores/m <sup>3</sup> )	7			7			7		
Hyphal Fragments	5	35					1	7	
Pollen									
Spore Trap Used	AOC			AOC			AOC		
	raw ct.	spores/m <sup>3</sup>	%	raw ct.	spores/m <sup>3</sup>	%	raw ct.	spores/m <sup>3</sup>	%
Alternaria									
Ascospores							9	63	18
Basidiospores	12	84	30				3	21	6
Bipolaris/Drechslera									
Chaetomium	1	7	3						
Cladosporium	20	140	50	12	84	60	15	105	30
Curvularia									
Epicoccum	1	7	3				7	49	14
Cercospora									
Fusarium									
Memnoniella									
Nigrospora									
Penicillium/Aspergillus	4	28	10	6	42	30	15	105	30
Polythrincium									
Rusts									
Smuts/Periconia/Myxomy	2	14	5	2	14	10	1	7	2
Spegazzinia									
Stachybotrys									
Stemphylium									
Tetraploa									
Torula									
Ulocladium									
Colorless/Other Brown 2									
Oidium									
Zygomycetes									
Pithomyces									
Background debris (1-5)3	3			2			3		
Sample Volume(liters)	150			150			150		
<b>TOTAL SPORES/M<sup>3</sup></b>	<b>40</b>	<b>280</b>		<b>20</b>	<b>140</b>		<b>50</b>	<b>350</b>	

Comments: Condition of the sample(s) upon receipt: Acceptable.

1=Total % may not equal 100 due to rounding.

2 = Colorless,other Brown are spores without a distinctive morphology on spore traps and non-viable surface samples.

3 = Background debris is the amount of particulate matter present on the slide and is graded from 1-5 with 1 = very light, 2= Light, 3 = Medium, 4 = Heavy, 5 = Very Heavy. The higher the rating the more likelihood spores may be underestimated. A rating of 5 should be interpreted as minimal counts and may actually be higher than reported.

The reporting limit is 1 Spore/sample.

Disclaimer: This report relates only to the samples tested  
Respectfully submitted, SEEML

506 Laurens Road  
Greenville, SC 29607  
Phone: (864) 233- 3770

Fax: (864) 233-6589

AIHA-LAP, LLC EMLAP # 173667

*Rafael Berrios*

Rafael Berrios, Approved Laboratory Signatory

# Spore Trap Report

	Date Sampled: 06/08/16
Attn: Rob Rowley	Date Received: 06/10/16
Skelly and Loy, Inc	Date Analyzed: 06/10/16
449 Eisenhower Blvd.	Date Reported: 06/10/16
Harrisburg, PA 17111	Date Revised:
	Project Name: Glenwood Middle School
	Project Address: 2680 Route 97
	Project City, State, ZIP: Glenwood, MD.21738
	SEEML Reference #: 160610045

**TEST METHOD: DIRECT MICROSCOPY EXAMINATION AT 400X (100% OF TRACE ANALYZED) SEEML SOP 7**

Client Sample ID	Classroom 20			Classroom 27			Classroom 28		
Location	Middle of Room			Middle of Room			Middle of Room		
Lab Sample ID	160610045-191			160610045-192			160610045-193		
Detection Limit (spores/m <sup>3</sup> )	7			7			7		
Hyphal Fragments							2	14	
Pollen									
Spore Trap Used	AOC			AOC			AOC		
	raw ct.	spores/m <sup>3</sup>	%	raw ct.	spores/m <sup>3</sup>	%	raw ct.	spores/m <sup>3</sup>	%
Alternaria									
Ascospores							5	35	16
Basidiospores	3	21	10	12	84	23	3	21	10
Bipolaris/Drechslera							1	7	3
Chaetomium									
Cladosporium	24	168	80	24	168	46	12	84	39
Curvularia									
Epicoccum							1	7	3
Cercospora									
Fusarium									
Memnoniella									
Nigrospora									
Penicillium/Aspergillus	3	21	10	15	105	29	9	63	29
Polythrincium									
Rusts									
Smuts/Periconia/Myxomy				1	7	2			
Spegazzinia									
Stachybotrys									
Stemphylium									
Tetraploa									
Torula									
Ulocladium									
Colorless/Other Brown 2									
Oidium									
Zygomycetes									
Pithomyces									
Background debris (1-5)3	2			3			3		
Sample Volume(liters)	150			150			150		
<b>TOTAL SPORES/M<sup>3</sup></b>	<b>30</b>	<b>210</b>		<b>52</b>	<b>364</b>		<b>31</b>	<b>217</b>	

Comments: Condition of the sample(s) upon receipt: Acceptable.

1=Total % may not equal 100 due to rounding.

2 = Colorless,other Brown are spores without a distinctive morphology on spore traps and non-viable surface samples.

3 = Background debris is the amount of particulate matter present on the slide and is graded from 1-5 with 1 = very light, 2= Light, 3 = Medium, 4 = Heavy, 5 = Very Heavy. The higher the rating the more likelihood spores may be underestimated. A rating of 5 should be interpreted as minimal counts and may actually be higher than reported.

The reporting limit is 1 Spore/sample.

Disclaimer: This report relates only to the samples tested

Respectfully submitted, SEEML

506 Laurens Road  
Greenville, SC 29607  
Phone: (864) 233- 3770

Fax: (864) 233-6589

AIHA-LAP, LLC EMLAP # 173667

*Rafael Berrios*

Rafael Berrios, Approved Laboratory Signatory

# Spore Trap Report

	Date Sampled: 06/08/16
Attn: Rob Rowley	Date Received: 06/10/16
Skelly and Loy, Inc	Date Analyzed: 06/10/16
449 Eisenhower Blvd.	Date Reported: 06/10/16
Harrisburg, PA 17111	Date Revised:
	Project Name: Glenwood Middle School
	Project Address: 2680 Route 97
	Project City, State, ZIP: Glenwood, MD.21738
	SEEML Reference #: 160610045

**TEST METHOD: DIRECT MICROSCOPY EXAMINATION AT 400X (100% OF TRACE ANALYZED) SEEML SOP 7**

Client Sample ID	Classroom 34			Classroom 35			Classroom 81		
Location	Middle of Room			Middle of Room			Middle of Room		
Lab Sample ID	160610045-194			160610045-195			160610045-196		
Detection Limit (spores/m <sup>3</sup> )	7			7			7		
Hyphal Fragments							10	70	
Pollen	1	7							
Spore Trap Used	AOC			AOC			AOC		
	raw ct.	spores/m <sup>3</sup>	%	raw ct.	spores/m <sup>3</sup>	%	raw ct.	spores/m <sup>3</sup>	%
Alternaria				1	7	2	1	7	<1
Ascospores	4	28	11	15	105	24	30	210	19
Basidiospores	3	21	8	12	84	19	33	231	21
Bipolaris/Drechslera									
Chaetomium									
Cladosporium	21	147	58	6	42	10	84	588	53
Curvularia									
Epicoccum	1	7	3	4	28	6	7	49	4
Cercospora									
Fusarium									
Memnoniella									
Nigrospora									
Penicillium/Aspergillus	6	42	17	24	168	38	3	21	2
Polythrincium									
Rusts				1	7	2			
Smuts/Periconia/Myxomy	1	7	3				2	14	1
Spegazzinia									
Stachybotrys									
Stemphylium									
Tetraploa									
Torula									
Ulocladium									
Colorless/Other Brown 2									
Oidium									
Zygomycetes									
Pithomyces									
Background debris (1-5)3	3			3			3		
Sample Volume(liters)	150			150			150		
<b>TOTAL SPORES/M<sup>3</sup></b>	<b>36</b>	<b>252</b>		<b>63</b>	<b>441</b>		<b>160</b>	<b>1120</b>	

Comments: Condition of the sample(s) upon receipt: Acceptable.

1=Total % may not equal 100 due to rounding.

2 = Colorless,other Brown are spores without a distinctive morphology on spore traps and non-viable surface samples.

3 = Background debris is the amount of particulate matter present on the slide and is graded from 1-5 with 1 = very light, 2= Light, 3 = Medium, 4 = Heavy, 5 = Very Heavy. The higher the rating the more likelihood spores may be underestimated. A rating of 5 should be interpreted as minimal counts and may actually be higher than reported.

The reporting limit is 1 Spore/sample.

Disclaimer: This report relates only to the samples tested  
Respectfully submitted, SEEML

506 Laurens Road  
Greenville, SC 29607  
Phone: (864) 233- 3770

Fax: (864) 233-6589

AIHA-LAP, LLC EMLAP # 173667

*Rafael Berrios*

Rafael Berrios, Approved Laboratory Signatory

## Spore Trap Report

	Date Sampled: 06/08/16
Attn: Rob Rowley	Date Received: 06/10/16
Skelly and Loy, Inc	Date Analyzed: 06/10/16
449 Eisenhower Blvd.	Date Reported: 06/10/16
Harrisburg, PA 17111	Date Revised:
	Project Name: Glenwood Middle School
	Project Address: 2680 Route 97
	Project City, State, ZIP: Glenwood, MD.21738
	SEEML Reference #: 160610045

**TEST METHOD: DIRECT MICROSCOPY EXAMINATION AT 400X (100% OF TRACE ANALYZED) SEEML SOP 7**

Client Sample ID	Classroom 80			Out 1			Out 2 CY		
Location	Middle of Room			Ext of Room 81			Window Sill		
Lab Sample ID	160610045-197			160610045-198			160610045-199		
Detection Limit (spores/m <sup>3</sup> )	7			7			7		
Hyphal Fragments	6	42		8	56		16	112	
Pollen	1	7		8	56		9	63	
Spore Trap Used	AOC			AOC			AOC		
	raw ct.	spores/m <sup>3</sup>	%	raw ct.	spores/m <sup>3</sup>	%	raw ct.	spores/m <sup>3</sup>	%
Alternaria				3	21	2	12	84	3
Ascospores	30	210	23	29	203	20	99	693	22
Basidiospores	24	168	18				54	378	12
Bipolaris/Drechslera									
Chaetomium									
Cladosporium	63	441	48	102	714	69	249	1740	55
Curvularia									
Epicoccum				3	21	2	26	182	6
Cercospora									
Fusarium									
Memnoniella									
Nigrospora									
Penicillium/Aspergillus	12	84	9						
Polythrincium							1	7	<1
Rusts									
Smuts/Periconia/Myxomy	2	14	2	11	77	7	9	63	2
Spegazzinia									
Stachybotrys									
Stemphylium									
Tetraploa									
Torula				1	7	<1			
Ulocladium									
Colorless/Other Brown 2									
Oidium									
Zygomycetes									
Pithomyces									
Background debris (1-5)3	3			3			3		
Sample Volume(liters)	150			150			150		
<b>TOTAL SPORES/M<sup>3</sup></b>	<b>131</b>	<b>917</b>		<b>149</b>	<b>1040</b>		<b>450</b>	<b>3150</b>	

Comments: Condition of the sample(s) upon receipt: Acceptable.

1=Total % may not equal 100 due to rounding.

2 = Colorless,other Brown are spores without a distinctive morphology on spore traps and non-viable surface samples.

3 = Background debris is the amount of particulate matter present on the slide and is graded from 1-5 with 1 = very light, 2= Light, 3 = Medium, 4 = Heavy, 5 = Very Heavy. The higher the rating the more likelihood spores may be underestimated. A rating of 5 should be interpreted as minimal counts and may actually be higher than reported.

The reporting limit is 1 Spore/sample.

Disclaimer: This report relates only to the samples tested

Respectfully submitted, SEEML

506 Laurens Road  
Greenville, SC 29607  
Phone: (864) 233- 3770

Fax: (864) 233-6589

AIHA-LAP, LLC EMLAP # 173667

*Rafael Berrios*

Rafael Berrios, Approved Laboratory Signatory

# Spore Trap Report

	Date Sampled: 06/08/16
Attn: Rob Rowley	Date Received: 06/10/16
Skelly and Loy, Inc	Date Analyzed: 06/10/16
449 Eisenhower Blvd.	Date Reported: 06/10/16
Harrisburg, PA 17111	Date Revised:
	Project Name: Glenwood Middle School
	Project Address: 2680 Route 97
	Project City, State, ZIP: Glenwood, MD.21738
	SEEML Reference #: 160610045

**TEST METHOD: DIRECT MICROSCOPY EXAMINATION AT 400X (100% OF TRACE ANALYZED) SEEML SOP 7**

Client Sample ID	Kitchen			Boys Locker Room			Classroom 70		
Location	By Office Door			Center of Room			Middle of Room		
Lab Sample ID	160610045-200			160610045-201			160610045-202		
Detection Limit (spores/m <sup>3</sup> )	7			7			7		
Hyphal Fragments				3	21				
Pollen	2	14							
Spore Trap Used	AOC			AOC			AOC		
	raw ct.	spores/m <sup>3</sup>	%	raw ct.	spores/m <sup>3</sup>	%	raw ct.	spores/m <sup>3</sup>	%
Alternaria	2	14	2				1	7	1
Ascospores	21	147	26	6	42	24	21	147	21
Basidiospores				12	84	48	21	147	21
Bipolaris/Drechslera									
Chaetomium									
Cladosporium	54	378	67	6	42	24	42	294	43
Curvularia									
Epicoccum	2	14	2						
Cercospora									
Fusarium									
Memnoniella									
Nigrospora									
Penicillium/Aspergillus							6	42	6
Polythrincium									
Rusts									
Smuts/Periconia/Myxomy	1	7	1				7	49	7
Spegazzinia									
Stachybotrys									
Stemphylium									
Tetraploa									
Torula									
Ulocladium									
Colorless/Other Brown 2									
Oidium									
Zygomycetes									
Pithomyces	1	7	1	1	7	4			
Background debris (1-5)3	3			3			3		
Sample Volume(liters)	150			150			150		
<b>TOTAL SPORES/M<sup>3</sup></b>	<b>81</b>	<b>567</b>		<b>25</b>	<b>175</b>		<b>98</b>	<b>686</b>	

Comments: Condition of the sample(s) upon receipt: Acceptable.

1=Total % may not equal 100 due to rounding.

2 = Colorless,other Brown are spores without a distinctive morphology on spore traps and non-viable surface samples.

3 = Background debris is the amount of particulate matter present on the slide and is graded from 1-5 with 1 = very light, 2= Light, 3 = Medium, 4 = Heavy, 5 = Very Heavy. The higher the rating the more likelihood spores may be underestimated. A rating of 5 should be interpreted as minimal counts and may actually be higher than reported.

The reporting limit is 1 Spore/sample.

Disclaimer: This report relates only to the samples tested  
Respectfully submitted, SEEML

506 Laurens Road  
Greenville, SC 29607  
Phone: (864) 233- 3770

Fax: (864) 233-6589

AIHA-LAP, LLC EMLAP # 173667

*Rafael Berrios*

Rafael Berrios, Approved Laboratory Signatory

# Spore Trap Report

	Date Sampled: 06/08/16
Attn: Rob Rowley	Date Received: 06/10/16
Skelly and Loy, Inc	Date Analyzed: 06/10/16
449 Eisenhower Blvd.	Date Reported: 06/10/16
Harrisburg, PA 17111	Date Revised:
	Project Name: Glenwood Middle School
	Project Address: 2680 Route 97
	Project City, State, ZIP: Glenwood, MD.21738
	SEEML Reference # : 160610045

**TEST METHOD: DIRECT MICROSCOPY EXAMINATION AT 400X (100% OF TRACE ANALYZED) SEEML SOP 7**

Client Sample ID	Classroom 71			Classroom 60			Classroom 61		
Location	Middle of Room			Middle of Room			Middle of Room		
Lab Sample ID	160610045-203			160610045-204			160610045-205		
Detection Limit (spores/m <sup>3</sup> )	7			7			7		
Hyphal Fragments				12	84				
Pollen				4	28		1	7	
Spore Trap Used	AOC			AOC			AOC		
	raw ct.	spores/m <sup>3</sup>	%	raw ct.	spores/m <sup>3</sup>	%	raw ct.	spores/m <sup>3</sup>	%
Alternaria				10	70	6			
Ascospores	1	7	3	24	168	15	6	42	15
Basidiospores	9	63	29	15	105	9	6	42	15
Bipolaris/Drechslera				1	7	<1			
Chaetomium									
Cladosporium	12	84	39	27	189	17	27	189	66
Curvularia				1	7	<1			
Epicoccum	1	7	3	24	168	15	2	14	5
Cercospora									
Fusarium									
Memnoniella									
Nigrospora									
Penicillium/Aspergillus	6	42	19	45	315	28			
Polythrincium									
Rusts				1	7	<1			
Smuts/Periconia/Myxomy	2	14	6	13	91	8			
Spegazzinia									
Stachybotrys									
Stemphylium									
Tetraploa									
Torula									
Ulocladium									
Colorless/Other Brown 2									
Oidium									
Zygomycetes									
Pithomyces									
Background debris (1-5)3	3			3			3		
Sample Volume(liters)	150			150			150		
<b>TOTAL SPORES/M<sup>3</sup></b>	<b>31</b>	<b>217</b>		<b>161</b>	<b>1130</b>		<b>41</b>	<b>287</b>	

Comments: Condition of the sample(s) upon receipt: Acceptable.

1=Total % may not equal 100 due to rounding.

2 = Colorless,other Brown are spores without a distinctive morphology on spore traps and non-viable surface samples.

3 = Background debris is the amount of particulate matter present on the slide and is graded from 1-5 with 1 = very light, 2= Light, 3 = Medium, 4 = Heavy, 5 = Very Heavy. The higher the rating the more likelihood spores may be underestimated. A rating of 5 should be interpreted as minimal counts and may actually be higher than reported.

The reporting limit is 1 Spore/sample.

Disclaimer: This report relates only to the samples tested

Respectfully submitted, SEEML

506 Laurens Road  
Greenville, SC 29607  
Phone: (864) 233- 3770

Fax: (864) 233-6589

AIHA-LAP, LLC EMLAP # 173667

*Rafael Berrios*

Rafael Berrios, Approved Laboratory Signatory

# Spore Trap Report

	Date Sampled: 06/08/16
Attn: Rob Rowley	Date Received: 06/10/16
Skelly and Loy, Inc	Date Analyzed: 06/10/16
449 Eisenhower Blvd.	Date Reported: 06/10/16
Harrisburg, PA 17111	Date Revised:
	Project Name: Glenwood Middle School
	Project Address: 2680 Route 97
	Project City, State, ZIP: Glenwood, MD.21738
	SEEML Reference # : 160610045

**TEST METHOD: DIRECT MICROSCOPY EXAMINATION AT 400X (100% OF TRACE ANALYZED) SEEML SOP 7**

Client Sample ID	Outside 3			Outside 4					
Location	Window Sill			On Concrete Walkway					
Lab Sample ID	160610045-206			160610045-207					
Detection Limit (spores/m <sup>3</sup> )	7			7					
Hyphal Fragments									
Pollen	9	63		8	56				
Spore Trap Used	AOC			AOC					
	raw ct.	spores/m <sup>3</sup>	%	raw ct.	spores/m <sup>3</sup>	%			
Alternaria	2	14	<1	6	42	2			
Ascospores	72	504	24	59	413	24			
Basidiospores	69	483	23	9	63	4			
Bipolaris/Drechslera	1	7	<1						
Chaetomium									
Cladosporium	138	966	46	126	882	51			
Curvularia									
Epicoccum	15	105	5	21	147	9			
Cercospora									
Fusarium									
Memnoniella									
Nigrospora				1	7	<1			
Penicillium/Aspergillus									
Polythrincium				1	7	<1			
Rusts				1	7	<1			
Smuts/Periconia/Myxomy	5	35	2	22	154	9			
Spegazzinia									
Stachybotrys									
Stemphylium									
Tetraploa									
Torula									
Ulocladium									
Colorless/Other Brown 2									
Oidium									
Zygomycetes									
Pithomyces									
Background debris (1-5)3	3			3					
Sample Volume(liters)	150			150					
<b>TOTAL SPORES/M<sup>3</sup></b>	<b>302</b>	<b>2110</b>		<b>246</b>	<b>1720</b>				

Comments: Condition of the sample(s) upon receipt: Acceptable.

1=Total % may not equal 100 due to rounding.

2 = Colorless,other Brown are spores without a distinctive morphology on spore traps and non-viable surface samples.

3 = Background debris is the amount of particulate matter present on the slide and is graded from 1-5 with 1 = very light, 2= Light, 3 = Medium, 4 = Heavy, 5 = Very Heavy. The higher the rating the more likelihood spores may be underestimated. A rating of 5 should be interpreted as minimal counts and may actually be higher than reported.

The reporting limit is 1 Spore/sample.

Disclaimer: This report relates only to the samples tested  
Respectfully submitted, SEEML

506 Laurens Road  
Greenville, SC 29607  
Phone: (864) 233- 3770

Fax: (864) 233-6589

AIHA-LAP, LLC EMLAP # 173667

*Rafael Berrios*

Rafael Berrios, Approved Laboratory Signatory

# Fungal Descriptions

## Alternaria sp.

---

Aw - 0.89. Conidia dimensions: 18-83 x 7-18 microns. A very common allergen with an IgE mediated response. It is often found in carpets, textiles and on horizontal surfaces in building interiors. Often found on window frames. Outdoors it may be isolated from samples of soil, seeds and plants. It is commonly found in outdoor samples. The large spore size, 20 - 200 microns in length and 7 - 18 microns in sizes, suggests that the spores from these fungi will be deposited in the nose, mouth and upper respiratory tract. It may be related to bakers' asthma. It has been associated with hypersensitivity pneumonitis. The species *Alternaria alternata* is capable of producing tenuazonic acid and other toxic metabolites that may be associated with disease in humans or animals. Common cause of extrinsic asthma (immediate-type hypersensitivity: type I). Acute symptoms include edema and bronchospasms; chronic cases may develop pulmonary emphysema.

## Ascospore

---

A spore borne in a special cell called an ascus. Spores of this type are reported to be allergenic. All ascomycetes, members of a group of fungi called Ascomycotina, have this type of spore. The minute black dots on rotting wood and leaves or the little cups on lichens are examples of ascomycetes; another is the "truffle" mushroom.

## Aspergillus/Penicillium

---

These are two of the most commonly found allergenic fungi in problem buildings. *Aspergillus* comes in many varieties (species). Many of the varieties produce toxic substances. It may be associated with symptoms such as sinusitis, allergic bronchiopulmonary aspergillosis, and other allergic symptoms. *Penicillium* is a variety of mold that is very common indoors and is found in increased numbers in problem buildings. It also has many varieties, some of which produce toxic substances. The symptoms are allergic reactions, mucous membrane irritation, headaches, vomiting, and diarrhea. Because the spores of *Aspergillus* and *Penicillium* are very similar, they are not differentiated by microscopic analysis and are reported together.

## Aspergillus sp.

---

Aw 0.75 - 0.82. Reported to be allergenic. Members of this genus are reported to cause ear infections. Many species produce mycotoxins that may be associated with disease in humans and other animals. Toxin production is dependent on the species or a strain within a species and on the food source for the fungus. Some of these toxins have been found to be carcinogenic in animal species. Several toxins are considered potential human carcinogens. Common cause of extrinsic asthma (immediate-type hypersensitivity: type I). Acute symptoms include edema and bronchospasms; chronic cases may develop pulmonary emphysema; may also be associated with sinusitis, allergic bronchiopulmonary aspergillosis, and other allergic symptoms.

## Basidiospore

---

Spore from basidiomycetes. Many varieties are reported to be allergenic.

## Bipolaris sp.

---

A fungus with large spores that could be expected to be deposited in the upper respiratory tract. This fungus can produce the mycotoxin - sterigmatocystin, which has been shown to produce liver and kidney damage when ingested by laboratory animals.

## Botrytis sp.

---

Aw 0.93. Conidia dimensions: 7-14 x 5-9 microns. It is parasitic on plants and soft fruits. Found in soil and on house plants and vegetables, it is also known as "gray mold". It causes leaf rot on grapes, strawberries, lettuce, etc. It is a well-known allergen, producing asthma type symptoms in greenhouse workers and "wine grower's lung".

## Cercospora

---

Common outdoors in agricultural areas, especially during harvest. Parasite of higher plants, causing leaf spot. Commonly found as parasites on higher plants.

## Chaetomium sp.

---

large ascomycetous fungus producing perithecia. It is found on a variety of substrates containing cellulose, including paper and plant compost. It has been found on paper in sheetrock. It can produce an *Acremonium*-like state on fungal media. Varieties are considered allergenic and have been associated with peritonitis, cutaneous lesions, and system mycosis.

## Cladosporium sp.

---

Aw 0.88; Aw 0.84. Most commonly identified outdoor fungus. The outdoor numbers are reduced in the winter. The numbers are often high in the summer. Often found indoors in numbers less than outdoor numbers. It is a common allergen. Indoor *Cladosporium* sp. may be different than the species identified outdoors. It is commonly found on the surface of fiberglass duct liners in the interior of supply ducts. A wide variety of plants are food sources for this fungus. It is found on dead plants, woody plants, food, straw, soil, paint, and textiles. Produces greater than 10 antigens. Antigens in commercial extracts are of variable quality and may degrade within weeks of preparation. Common cause of extrinsic asthma (immediate-type hypersensitivity: type I). Acute symptoms include skin lesions, eye ulceration, mycosis (including onychomycosis, an infection of the nails of the feet or hands) edema and bronchospasms; chronic cases may develop pulmonary emphysema.

## Curvularia sp.

---

Reported to be allergenic and has been associated with allergic fungal sinusitis. It may cause corneal infections, mycetoma, and infections in immune compromised hosts.

## Dreschlera sp.

---

Conidia dimensions: 40-120 x 17-28 microns. Found on grasses, grains and decaying food. It can occasionally cause a corneal infection of the eye.

## Epicoccum sp.

---

Conidia dimensions: 15-25 microns. A common allergen. It is found in plants, soil, grains, textiles and paper products.

## Fusarium sp.

---

Aw 0.90. A common soil fungus. It is found on a wide range of plants. It is often found in humidifiers. Several species in this genus can produce potent trichothecene toxins. The trichothecene (scirpene) toxin targets the following systems: circulatory, alimentary, skin, and nervous. Produces vomitoxin on grains during unusually damp growing conditions. Symptoms may occur either through ingestion of contaminated grains or possibly inhalation of spores. The genera can produce hemorrhagic syndrome in humans (alimentary toxic aleukia). This is characterized by nausea, vomiting, diarrhea, dermatitis, and extensive internal bleeding. Reported to be allergenic. Frequently involved in eye, skin, and nail infections.

## Myxomycetes

---

Members of a group of fungi that is included in the category of "slime molds". They're occasionally found indoors, but mainly reside in forested regions on decaying logs, stumps, and dead leaves. Myxomycetes display characteristics of fungi *and* protozoans. In favorable (wet) conditions they exhibit motile, amoeba-like cells, usually bounded only by a plasma membrane, that are variable in size and form. During dry spells, they form a resting body (sclerotium) with dry, airborne spores. These fungi are not known to produce toxins, but can cause hay fever and asthma.

## Memnoniella

---

Contaminant, found most often with *Stachybotrys* on wet cellulose. Forms in chains, but it are very similar to *Stachybotrys* and sometimes is considered to be in the *Stachybotrys* family. Certain species do produce toxins very similar to the ones produced by *Stachybotrys chartarum* and many consider the IAQ importance of *Memnoniella* to be on par with *Stachybotrys*. Allergenic and infectious properties are not well studied.

## **Nigrospora sp.**

---

Commonly found in warm climates, this mold may be responsible for allergic reactions such as hay fever and asthma. It is found on decaying plant material and in the soil. It is not often found indoors.

## **Oidium sp.**

---

The asexual phase of *Erysiphe* sp. It is a plant pathogen causing powdery mildews. It is very common on the leaves stems, and flowers of plants. The health effects and allergenicity have not been studied. It does not grow on non-living surfaces such as wood or drywall.

## **Penicillium sp.**

---

Aw 0.78 - 0.88. A wide number of organisms have been placed in this genus. Identification to species is difficult. Often found in aerosol samples. Commonly found in soil, food, cellulose and grains. It is also found in paint and compost piles. It may cause hypersensitivity pneumonitis, allergic alveolitis in susceptible individuals. It is reported to be allergenic (skin). It is commonly found in carpet, wallpaper, and in interior fiberglass duct insulation. Some species can produce mycotoxins. Common cause of extrinsic asthma (immediate-type hypersensitivity: type I). Acute symptoms include edema and bronchospasms; chronic cases may develop pulmonary emphysema. It may also cause headaches, vomiting, and diarrhea.

## **Periconia sp.**

---

found in soil, blackened and dead herbaceous stems leaf spots, grasses, rushes, and sedges. Almost always associated with other fungi. Rarely found growing indoors. Reportedly associated with a rare case of mycotic keratitis.

## **Pithomyces sp.**

---

A common mold found on dead leaves, plants, soil and especially grasses. Causes facial eczema in ruminants. It exhibits distinctive multi-celled brown conidia. It is not known to be a human allergen or pathogen. It is rarely found indoors, although it can grow on paper.

## **Polythrincium sp.**

---

Polythrincium species comprise a very small proportion of the fungal biota. This genus is somewhat related to Ramularia. No information is available regarding health effects, or toxicity. Allergenicity has not been studied. Our laboratory has never seen this organism growing on environmental surfaces. May be identified in air on spore trap samples (spores have distinctive morphology). Also, spores may be seen in dust as part of the normal influx of outdoor microbial particles. Natural habitat is on leaves.

## Rusts/Smuts

---

These fungi are associated with plant diseases. In the classification scheme of the fungi, the smuts have much in common with the rusts, and they are frequently discussed together. Both groups produce wind-borne, resistant teliospores that serve as the basis for their classification and their means of spread. Rusts usually attack vegetative regions (i.e., leaves and stems) of plants; smuts usually are associated with the reproductive structures (seeds). They can cause hay fever and asthma.

## Spegazzinia

---

Spegazzinia species comprise a very small proportion of the fungal biota. This genus is somewhat related to other lobed or ornamented genera such as *Candelabrum*. No information is available regarding health effects or toxicity. Allergenicity has not been studied. Usually identified on spore trap samples where it is seen every few weeks. (Spores have very distinctive morphology.) May also be found in air by culturable (Andersen) samples if a long enough incubation period is provided so that sporulation occurs. Our laboratory has never found this organism growing on indoor environmental surfaces. Natural habitat includes soil and many kinds of trees and plants.

## Stachybotrys sp.

---

Aw - 0.94 , optimum Aw  $\rightarrow$  0.98. Several strains of this fungus (*S. atra*, *S. chartarum* and *S. alternans* are synonymous) may produce a trichothecene mycotoxin- Satratoxin H - which is poisonous by inhalation. The toxins are present on the fungal spores. This is a slow growing fungus on media. It does not compete well with other rapidly growing fungi. The dark colored fungus grows on building material with high cellulose content and low nitrogen content. Areas with a relative humidity above 55%, and are subject to temperature fluctuations, are ideal for toxin production.

Individuals with chronic exposure to the toxin produced by this fungus reported cold and flu symptoms, sore throats, diarrhea, headaches, fatigue, dermatitis, intermittent local hair loss and generalized malaise. Other symptoms include coughs, rhinitis, nosebleed, a burning sensation in the nasal passages, throat, and lungs, and fever. The toxins produced by this fungus will suppress the immune system affecting the lymphoid tissue and the bone marrow. Animals injected with the toxin from this fungus exhibited the following symptoms: necrosis and hemorrhage within the brain, thymus, spleen, intestine, lung, heart, lymph node, liver, and kidney. Affects by absorption of the toxin in the human lung are known as pneumomycosis.

This organism is rarely found in outdoor samples. It is usually difficult to find in indoor air samples unless it is physically disturbed (or possibly -this is speculation- a drop in the relative humidity). The spores are in a gelatinous mass. Appropriate media for the growth of this organism will have high cellulose content and low nitrogen content. The spores will die readily after release. The dead spores are still allergenic and toxigenic. Percutaneous absorption has caused mild symptoms.

## **Stemphylium sp.**

---

Reported to be allergenic. Isolated from dead plants and cellulose materials.

## **Taeniolella sp.**

---

contaminant primarily grows on wood. It was isolated from human cutaneous and subcutaneous lesions.

## **Torula sp.**

---

Found outdoors in air, soil, on dead vegetation, wood, and grasses. Also found indoors on cellulose materials. Reported to be allergenic and may cause hay fever and asthma.

## **Tetraploa**

---

Tetraploa species comprise a very small proportion of the fungal biota. This genus is somewhat related to Triposporium and Diplocladiella. The only reported human infections are two cases of keratitis (1970, 1980) and one case of subcutaneous infection of the knee (1990). No information is available regarding other health effects or toxicity. Allergenicity has not been studied. Usually identified on spore trap samples where it is seen every few weeks. (Spores have very distinctive morphology.) Our laboratory has never found this organism growing on indoor environmental surfaces. Natural habitat includes leaf bases and stems just above the soil on many kinds of plants and trees.

## **Ulocladium sp.**

---

Aw 0.89. Isolated from dead plants and cellulose materials. Found on textiles.

## **Zygomycetes**

---

Zygomycetes are one of the four major groups of fungi, the others being the Oomycetes, the Ascomycetes, and the Basidiomycetes. Zygomycetes are common, fast growing, and often overgrow and/or inhibit other fungi nearby. Rhizopus and Mucor are two of the most common Zygomycetes seen in the indoor environment. However, others are seen as well, including Syncephalastrum, Circinella, Mortierella, Mycotypha, Cunninghamella, and Choanephora. For further information, please see descriptions of these individual genera.

The following table lists mycotoxins that are produced by certain types of fungi:

<b>Fungi</b>	<b>Mycotoxin</b>
Acremonium crocinigenum	Crocin
Aspergillus favus	Alfatoxin B, cyclopiazonic acid
Aspergillus fumigatus	Fumagilin, gliotoxin
Aspergillus carneus	Citrinin
Aspergillus clavatus	Cytochalasin, patulin
Aspergillus Parasiticus	Alfatoxin B
Aspergillus nomius	Alfatoxin B
Aspergillus niger	Ochratoxin A, malformin, oxalic acid
Acremonium crocinigenum	Crocin
Aspergillus nidulans	Sterigmatocystin
Aspergillus ochraceus	Ochratoxin A, penicillic acid
Aspergillus versicolor	Sterigmatocystin, 5 ethoxysterigmatocystin
Aspergillus ustus	Ausdiol, austamide, austocystin, brevianamide
Aspergillus terreus	Citreoviridin
Alternaria	Alternariol, altertoxin, altenuene, altenusin, tenuazonic acid
Arthrinium	Nitropropionic acid
Bioploaris	Cytochalasin, sporidesmin, sterigmatocystin
Chaetomium	Chaetoglobosin A,B,C. Sterigmatocystin
Cladosporium	Cladosporic acid
Clavipes purpurea	Ergotism
Cylindrocarpum	Trichothecene
Diplodia	Diplodiatoxin
Fusarium	Trichothecene, zearalenone
Fusarium moniliforme	Fumonisin
Emericella nidulans	Sterigmatocystin
Gliocladium	Gliotoxin
Memnoniella	Griseofulvin, dechlorogriseofulvin, epi-dechlorogriseofulvin, trichodermin, trichodermol
Myrothecium	Trichothecene
Paecilomyces	Patulin, viriditoxin
Penicillium aurantiocandidum	Penicillic acid
Penicillium aurantiogriseum	Penicillic acid
Penicillium brasilianum	Penicillic acid
Penicillium brevicompactum	Mycophenolic acid
Penicillium camemberti	Cyclopiazonic acid
Penicillium carneum	Mycophenolic acid, Roquefortine C
Penicillium crateriforme	Rubratoxin

Penicillium citrinum	Citrinin
Penicillium commune	Cyclopiazonic acid
Penicillium crustosum	Roquefortine C
Penicillium chrysogenum	Roquefortine C
Penicillium discolor	Chaetoglobosin C
Penicillium expansum	Citrinin, Roquefortine C
Penicillium griseofulvum	Roquefortine C, cyclopiazonic acid, griseofulvin
Penicillium hirsutum	Roquefortine C
Penicillium hordei	Roquefortine C
Penicillium nordicum	Ochratoxin A
Penicillium paneum	Roquefortine C
Penicillium palitans	Cyclopiazonic acid
Penicillium polonicum	Penicillic acid
Penicillium roqueforti	Roquefortine C, Mycophenolic acid
Penicillium veridicatum	Penicillic acid
Penicillium verrucosum	Citrinin, ochratoxin A
Penicillium/ Aspergillus	Patulin
Penicillium/ Aspergillus/Alternaria	Glitoxin
Phomopsis	Macrocyclic trichothecenes
Phoma	Brefeldin, cytochalasin, secalonic acid, tenuazonic acid
Pithomyces	Sporidesmin
Rhizoctonia	Slaframine
Rhizopus	Rhizonin
Sclerotinia	Furanocoumarins
Stachybotrys chartarum	Iso-satratoxin F, roridin E, L-2, satratoxin G & H, trichodermin, trichodermol, trichothecene
Torula	Cytotoxins
Trichoderma	Trichodermin, trichodermol, gliotoxin
Trichothecium	Trichothecene
Wallemia	Walleminol
Zygosporium	Cytochalasin

## General terms

### Allergen

---

An allergen is a substance that elicits an IgE antibody response and is responsible for producing allergic reactions. Chemicals are released when IgE on certain cells come into contact with an allergen. These chemicals can cause injury to surrounding tissue - the visible signs of an allergy. Only a few fungal allergens have been characterized but all fungi are thought to be potentially allergenic. Fungal allergens are proteins found in either the mycelium or spores

### "Black mold"

---

The poorly defined term? Black mold? Or? Toxic black mold? Has usually been associated with the mold *Stachybotrys chartarum*. While there are only a few molds that are truly black, there are many that can appear black. Not all molds that appear to be black are *Stachybotrys*.

### Fungi

---

Fungi are neither animals nor plants and are classified in a kingdom of their own? The Kingdom of Fungi. Fungi include a very large group of organisms, including molds, yeasts, mushrooms and puffballs. There are >100,000 accepted fungal species but current estimates range to 1.5 million species. Mycologists (people who study fungi) have grouped fungi into four large groups according to their method of reproduction.

### Hidden mold

---

This refers to visible mold growth on building structures that is not easily seen, including the areas above drop ceilings, within a wall cavity (the space between the inner and outer structure of a wall), inside air handlers, or within the ducting of a heating/ventilation system.

### Microbial Volatile Organic Compounds (MVOCs)

---

Fungi produce chemicals as a result of their metabolism. Some of these chemicals, MVOCs, are responsible for the characteristic moldy, musty, or earthy smell of fungi, whether mushrooms or molds. Some MVOCs are considered offensive or annoying. Specific MVOCs are thought to be characteristic of wood rot and mold growth on building materials. The human nose is very sensitive to mold odors and sometimes more so than current analytical instruments.

## Mold

---

Molds are a group of organisms that belong to the Kingdom of Fungi (see Fungi). Even though the terms mold and fungi had been commonly referred to interchangeably, all molds are fungi, but not all fungi are molds.

## Mycotoxin

---

Mycotoxins are compounds produced by some fungi that are toxic to humans or animals. By convention, the term? Mycotoxin? Excludes mushroom toxins. Fungi that produce mycotoxins are called "toxigenic fungi.

## Spore

---

General Term for a reproductive structure in fungi, bacteria and some plants. In fungi, the spore is the structure which may be used for dissemination and may be resistant to adverse environmental conditions.

## Toxic mold

---

The term? Toxic mold" has no scientific meaning since the mold itself is not toxic. The metabolic byproducts of some molds may be toxic (see mycotoxin).

## Hypha (plural, hyphae)

---

An individual fungal thread or filament of connected cells; the thread that represents the individual parts of the fungal body.



**Southeast Environmental Microbiology Laboratories**  
**Chain of Custody**

506 Laurens Rd, Greenville, SC 29607

Phone : 864-233-3770, Fax: 864-233-3779, www.seeml.com, AIHA-LAP, LLC. (EMLAP) #173667

Page 1 of 2

For Lab Use Only

Condition of samples is acceptable	<input checked="" type="checkbox"/> YES <input type="checkbox"/> NO	SEEML Ref #: <u>160610045</u>	Lab ID: <u>188-207</u>
------------------------------------	---	-------------------------------	------------------------

Company Information	Client Information	Environmental Conditions
(Project Manager) <u>Rob Rowley</u>	Date Sampled: <u>6/8/16</u>	Precipitation in last 16hrs:
(Company Name) <u>Skelly + Loy</u>	Project Name: <u>Glenwood Middle School</u>	Relative Humidity I/O: <u>/</u>
(Address) <u>449 Eisenhower Blvd</u>	Project Address: <u>2680 Route 97</u>	Temperature I/O: <u>/</u>
(City, State, Zip) <u>Harrisburg, PA 17111</u>	City, State, Zip: <u>Glenwood, MD 21738</u>	Wind Conditions
(Phone) <u>717-232-0593</u>	<b>Sample Type Abbreviations:</b> A- Allergenco   S-Swab   AP-Andersen Plate AOC- Air O Cell   T-Tape   W- Water M5- Micro 5   B- Bulk   D- Dust	<b>Analysis Type:</b> * <u>invoice to: RID-D163.019.01. DIR</u> 1. SporeTrap, Air Sample Analysis-Same Day 2. Direct Exam Surface Sample Analysis -Same Day 3. Culturable Air / Surface Samples -7-10 days
(Email) <u>RRowley@skellyloy.com</u>		

Sample ID	Sample Location	Sample Type	Analysis Type	*Area	**Volume (L)	Notes
<u>Classroom 3</u>	<u>middle of room</u>	<u>AIDC</u>	<u>1</u>		<u>150</u>	
<u>Classroom 4</u>	↓	↓	↓			
<u>Classroom 19</u>						
<u>Classroom 20</u>						
<u>Classroom 27</u>						
<u>Classroom 28</u>						
<u>Classroom 34</u>						
<u>Classroom 35</u>						
<u>Classroom 81</u>						
<u>Classroom 80</u>						

Relinquished By: <u>[Signature]</u>	Date/Time: <u>6/9/16</u>
-------------------------------------	--------------------------

Received By: <u>[Signature]</u>	Date/Time: <u>6-10-16</u>
---------------------------------	---------------------------

\* Area is only required for culturable surface samples.  
 \*\* Volume = Pump setting (L/min) x minutes



**Southeast Environmental Microbiology Laboratories**  
**Chain of Custody**

506 Laurens Rd, Greenville, SC 29607

Phone : 864-233-3770, Fax: 864-233-3779, www.seeml.com, AIHA-LAP, LLC. (EMLAP) #173667

For Lab Use Only

Condition of samples is acceptable	<input checked="" type="checkbox"/> YES <input type="checkbox"/> NO	SEEML Ref #: <u>160610045</u>	Lab ID: <u>188-207</u>
------------------------------------	---	-------------------------------	------------------------

Company Information	Client Information	Environmental Conditions
(Project Manager) <u>Rob Rowley</u>	Date Sampled: <u>6/8/16</u>	Precipitation in last 16hrs:
(Company Name) <u>Skelly &amp; Loy</u>	Project Name: <u>Glenwood Middle School</u>	Relative Humidity I/O: <u>/</u>
(Address) <u>449 Eisenhower Blvd</u>	Project Address: <u>2680 Route 97</u>	Temperature I/O: <u>/</u>
(City, State, Zip) <u>Harrisburg, PA 17111</u>	City, State, Zip: <u>Glenwood, MD 21738</u>	Wind Conditions:
(Phone) <u>717-232-0593</u>	<b>Sample Type Abbreviations:</b> A- Allergenco    S-Swab    AP-Andersen Plate AOC- Air O Cell    T-Tape    W- Water M5- Micro 5    B- Bulk    D- Dust	<b>Analysis Type:</b> <u>R10-0163.019.01 Dir</u> 1. SporeTrap, Air Sample Analysis-Same Day 2. Direct Exam Surface Sample Analysis -Same Day 3. Culturable Air / Surface Samples -7-10 days
(Email) <u>Rrowley@skellyloy.com</u>		
<u>717-874-0242</u>		

Sample ID	Sample Location	Sample Type	Analysis Type	*Area	**Volume (L)	Notes
<u>out 1</u>	<u>ext. of room 81</u>	<u>AOC</u>	<u>1</u>		<u>150</u>	
<u>out 2</u>	<u>window sill</u>	↓	↓		↓	
<u>Kitchen</u>	<u>by office door</u>	↓	↓		↓	
<u>boys locker room</u>	<u>center of room</u>	↓	↓		↓	
<u>classroom 70</u>	<u>middle of room</u>	↓	↓		↓	
<u>classroom 71</u>	↓	↓	↓		↓	
<u>classroom 60</u>	↓	↓	↓		↓	
<u>classroom 61</u>	↓	↓	↓		↓	
<u>outside 3</u>	<u>window sill</u>	↓	↓		↓	
<u>outside 4</u>	<u>on concrete walkway</u>	↓	↓		↓	

Relinquished By: <u>James Yelley</u>	Date/Time: <u>6/9/16</u>
--------------------------------------	--------------------------

Received By: <u>[Signature]</u>	Date/Time: <u>6/10/16</u>
---------------------------------	---------------------------

\* Area is only required for culturable surface samples.

\*\* Volume = Pump setting (L/min) x minutes



**AIHA Laboratory Accreditation Programs, LLC**

*acknowledges that*

**Southeast Environmental Microbiology Laboratories**

506-A Laurens Road, Greenville, SC 29607

Laboratory ID: 173667

along with all premises from which key activities are performed, as listed above, has fulfilled the requirements of the AIHA Laboratory Accreditation Programs (AIHA-LAP), LLC accreditation to the ISO/IEC 17025:2005 international standard, *General Requirements for the Competence of Testing and Calibration Laboratories* in the following:

**LABORATORY ACCREDITATION PROGRAMS**

- |  |                                   |
|--|-----------------------------------|
| <input type="checkbox"/> INDUSTRIAL HYGIENE                    | Accreditation Expires:            |
| <input type="checkbox"/> ENVIRONMENTAL LEAD                    | Accreditation Expires:            |
| <input checked="" type="checkbox"/> ENVIRONMENTAL MICROBIOLOGY | Accreditation Expires: 11/01/2017 |
| <input type="checkbox"/> FOOD                                  | Accreditation Expires:            |
| <input type="checkbox"/> UNIQUE SCOPES                         | Accreditation Expires:            |

Specific Field(s) of Testing (FoT)/Method(s) within each Accreditation Program for which the above named laboratory maintains accreditation is outlined on the attached **Scope of Accreditation**. Continued accreditation is contingent upon successful on-going compliance with ISO/IEC 17025:2005 and AIHA-LAP, LLC requirements. This certificate is not valid without the attached **Scope of Accreditation**. Please review the AIHA-LAP, LLC website ([www.aihaaccreditedlabs.org](http://www.aihaaccreditedlabs.org)) for the most current Scope.

*Gerald R. Schultz*

Gerald Schultz, CIH  
Chairperson, Analytical Accreditation Board

*Cheryl O. Morton*

Cheryl O. Morton  
Managing Director, AIHA Laboratory Accreditation Programs, LLC

Revision 14: 03/26/2014

Date Issued: 09/30/2015

**APPENDIX C -  
INSTRUMENT CALIBRATION LOGS**

## CALIBRATION LOG

Instrument Name: Zefon Biopump  
Serial Number: 1595  
Model Number: ZBD-200  
Date Calibrated: 6.8.16

Calibrated by: Lauren Tilley  
Signature: *Lauren Tilley*

S&L job number: R10-0163.019.01  
S&L job name: Glenwood

Pre calibration: 15 LPM w/ Flow meter air-o-cell rotometer  
Time: 11:30am  
Post Calibration: 15 LPM w/ Flow meter air-o-cell rotometer  
Time: 9:30pm

Instrument Name: Zefon Biopump  
Serial Number: 3401  
Model Number: ZBD-~~200~~ 100  
Date Calibrated: 6.8.16

Calibrated by: Lauren Tilley  
Signature: *Lauren Tilley*

S&L job number: R10-0163.019.01  
S&L job name: Glenwood

Pre calibration: 15 LPM w/ flow meter air-o-cell rotometer  
Time: 11:30am  
Post Calibration: 15 LPM w/ flow meter air-o-cell rotometer  
Time: 9:30pm

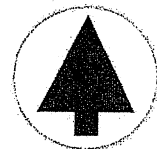

# INSTRUMENT CALIBRATION REPORT

Pine Environmental Services, LLC.

1016 West Eighth Ave  
King of Prussia, PA 19406

## Pine Environmental Services, Inc.

**Instrument ID** 16518  
**Description** TSI 982 Probe  
**Calibrated** 6/7/2016 1:16:38PM

<b>Manufacturer</b> Tsi	<b>State Certified</b>
<b>Model Number</b> Probe	<b>Status</b> Pass
<b>Serial Number/ Lot Number</b> 11100014	<b>Temp °C</b> 22
<b>Location</b> Philly	<b>Humidity %</b> 57
<b>Department</b>	

### Calibration Specifications

**Group #** 1  
**Group Name** CO2  
**Stated Accy** Pct of Reading

**Range Acc %** 0.0000  
**Reading Acc %** 3.0000  
**Plus/Minus** 0.00

<u>Nom In Val / In Val</u>	<u>In Type</u>	<u>Out Val</u>	<u>Out Type</u>	<u>End As</u>	<u>Lft As</u>	<u>Dev%</u>	<u>Pass/Fail</u>
1000.00 / 1000.00	PPM	1000.00	PPM	1,000.00	1,000.00	0.00%	Pass

**Group #** 2  
**Group Name** CO  
**Stated Accy** Pct of Reading

**Range Acc %** 0.0000  
**Reading Acc %** 3.0000  
**Plus/Minus** 0.00

<u>Nom In Val / In Val</u>	<u>In Type</u>	<u>Out Val</u>	<u>Out Type</u>	<u>End As</u>	<u>Lft As</u>	<u>Dev%</u>	<u>Pass/Fail</u>
100.00 / 100.00	PPM	100.00	PPM	100.00	100.00	0.00%	Pass

### Test Instruments Used During the Calibration

(As Of Cal Entry Date)

<u>Test Standard ID</u>	<u>Description</u>	<u>Manufacturer</u>	<u>Model Number</u>	<u>Serial Number / Lot Number</u>	<u>Last Cal Date / Opened Date</u>	<u>Next Cal Date / Expiration Date</u>
KOP CO100/CO2100 0 PPM FAO-375-1	CO100 PPM CO2 1000 OOM	American Gas Group	GP10733	FAO-375-1		5/19/2018

### Notes about this calibration

**Calibration Result** Calibration Successful  
**Who Calibrated** Allie Gibat

# INSTRUMENT CALIBRATION REPORT

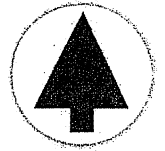

**Pine Environmental Services, LLC.**

1016 West Eighth Ave  
King of Prussia, PA 19406

## **Pine Environmental Services, Inc.**

---

**Instrument ID** 16518

**Description** TSI 982 Probe

**Calibrated** 6/7/2016 1:16:38PM

---

All instruments are calibrated by Pine Environmental Services, LLC. according to the manufacturer's specifications, but it is the customer's responsibility to calibrate and maintain this unit in accordance with the manufacturer's specifications and/or the customer's own specific needs.

**Notify Pine Environmental Services, LLC. of any defect within 24 hours of receipt of equipment  
Please call 866-960-7463 for Technical Assistance**



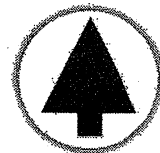

# INSTRUMENT CALIBRATION REPORT

**Pine Environmental Services, LLC.**

92 North Main St, Building 20  
Windsor, NJ 08561  
Toll-free: (800) 301-9663

## Pine Environmental Services, Inc.

**Instrument ID** 16518  
**Description** TSI 982 Probe  
**Calibrated** 5/27/2016 4:33:18PM

<b>Manufacturer</b> Tsi	<b>State Certified</b>
<b>Model Number</b> Probe	<b>Status</b> Pass
<b>Serial Number/ Lot Number</b> 11100014	<b>Temp °C</b> 26.6
<b>Location</b> New Jersey	<b>Humidity %</b> 45
<b>Department</b>	

### Calibration Specifications

Group # 1				Range Acc %			
Group Name CO2				Reading Acc %			
Stated Accy Pct of Reading				Plus/Minus			
<u>Nom In Val / In Val</u>	<u>In Type</u>	<u>Out Val</u>	<u>Out Type</u>	<u>Fnd As</u>	<u>Lft As</u>	<u>Dev%</u>	<u>Pass/Fail</u>
1000.00 / 1000.00	PPM	1000.00	PPM	984.00	999.00	-0.10%	Pass
Group # 2				Range Acc %			
Group Name CO				Reading Acc %			
Stated Accy Pct of Reading				Plus/Minus			
<u>Nom In Val / In Val</u>	<u>In Type</u>	<u>Out Val</u>	<u>Out Type</u>	<u>Fnd As</u>	<u>Lft As</u>	<u>Dev%</u>	<u>Pass/Fail</u>
100.00 / 100.00	PPM	100.00	PPM	98.90	100.30	0.30%	Pass

<u>Test Instruments Used During the Calibration</u>					<u>(As Of Cal Entry Date)</u>	
<u>Test Standard ID</u>	<u>Description</u>	<u>Manufacturer</u>	<u>Model Number</u>	<u>Serial Number / Lot Number</u>	<u>Last Cal Date/ Expiration Date</u>	<u>Next Cal Date / Expiration Date</u>
					<u>Opened Date</u>	
NJ CO / CO2 - DAP-375-1	NJ 100 CO/1000 CO2 34 Liters	American Gas Group	GP10733	DAP-375-1		3/9/2019
NJ NITROGEN - KAO-114-5	Nitrogen 99.999% 34 liters	American Gas Group	GP12307	KAO-114-5		10/28/2018

### Notes about this calibration

**Calibration Result** Calibration Successful  
**Who Calibrated** Dave German

# INSTRUMENT CALIBRATION REPORT

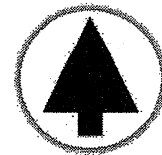

**Pine Environmental Services, LLC.**

92 North Main St, Building 20

Windsor, NJ 08561

Toll-free: (800) 301-9663

## **Pine Environmental Services, Inc.**

---

**Instrument ID** 16518

**Description** TSI 982 Probe

**Calibrated** 5/27/2016 4:33:18PM

---

All instruments are calibrated by Pine Environmental Services, LLC. according to the manufacturer's specifications, but it is the customer's responsibility to calibrate and maintain this unit in accordance with the manufacturer's specifications and/or the customer's own specific needs.

**Notify Pine Environmental Services, LLC. of any defect within 24 hours of receipt of equipment**

**Please call 866-960-7463 for Technical Assistance**

# INSTRUMENT CALIBRATION REPORT



Advanced Labs, Inc.

**Pine Environmental Services, Inc**

**Instrument ID** 25453  
**Description** TSI 8530 DustTrak II  
**Calibrated** 1/19/2016

**Manufacturer** TSI  
**Model Number** 8530  
**Serial Number** 8530141304  
**Location** New Jersey  
**Temp** 74

**Classification**  
**Status** pass  
**Frequency** Yearly EOM  
**Department** Lab  
**Humidity** 23

### Calibration Specifications

**Group #** 1  
**Group Name** Arizona Road Dust  
**Test Performed:** Yes      **As Found Result:** Fail      **As Left Result:** Pass

### Test Instruments Used During the Calibration

<u>Test Instrument ID</u>	<u>Description</u>	<u>Manufacturer</u>	<u>Serial Number</u>	<u>(As Of Cal Entry Date)</u>	
				<u>Last Cal Date</u>	<u>Next Cal Date</u>
DUST TRAK DRX MASTER 8533151105	TSI Dust Trak DRX Aerosol Monitor	TSI	8533151105	3/16/2015	3/16/2016
FLUKE 114	Fluke 114 NIST Traceable Multimeter	Fluke	15310288	4/25/2015	4/25/2016

### Notes about this calibration

photometric calibration ratio: 0.85

**Calibration Result** Calibration Successful  
**Who Calibrated** Kevin Cole

**Advanced Labs, Inc. hereby certifies that this instrument is calibrated and functions to meet the manufacture's specifications using NIST traceable standards, or is derived from accepted values of physical constants.**

# INSTRUMENT QC/ PACKING LIST

<b>Description</b>	Zefon Bio-Pump plus
<b>Instrument ID</b>	R18911
<b>Date Calibrated</b>	3-31-16



Standard Items	Prepared	QC check	Received by customer	Returned to Pine
Bio-Pump plus w/ case	/	/	_____	_____
Manual	/	/	_____	_____
Charger: 15V, 1.67 A output	/	/	_____	_____
Air-O-Cell flow indicator	/	/	_____	_____
<b>Supporting Items</b>				
Via-Cell/ Air-O-Cell CSI flow indicator	_____	_____	_____	_____
Air-O-Cell cassettes, quantity _____	_____	_____	_____	_____
Via-Cell cassettes, quantity _____	_____	_____	_____	_____
Air-O-Cell CSI cassettes, quantity _____	_____	_____	_____	_____

**Prepared by:** MH  
**QC checked by:** [Signature]  
**Date:** 3-31-16

*This packing list is to ensure that every item needed to operate the unit was sent and received. Upon receiving a shipment, please fill out the "Received by customer" column. Call Pine within 24 hours of receiving the equipment if any pieces are missing, damaged, or malfunctioning. Thank you for choosing Pine Environmental Services LLC*

# Comfort Parameters Log

Site Name: Glenwood Middle

Site Address: 2690 MD-97, Glenwood, MD 21738



Project Name: Howard County School System

Project Number: R10-0163.019 Task 1

Date Sampled/Assessed: 6/8/2016

Sample/Assessment Location	Time Sampled/Assessed	(CO <sub>2</sub> ) Carbon Dioxide (ppm)	Temp °F	% Relative Humidity	(CO) Carbon Monoxide (ppm)	Respirable Dusts mg/M3			Number of Occupants
						Mass	Min	Max	
Classroom 3	15:16	576	75.6	26.0%	0	0.005	0.005	0.005	0
Classroom 4	15:18	610	74.8	27.1%	0	0.004	0.004	0.004	0
Classroom 19	15:31	470	76.5	27.1%	0	0.008	0.004	0.008	0
Classroom 20	15:32	451	74.8	29.0%	0	0.005	0.004	0.005	0
Classroom 27	15:46	428	75.2	30.8%	0	0.005	0.004	0.005	0
Classroom 28	15:47	444	74.3	32.2%	0	0.005	0.004	0.006	0
Classroom 34	16:00	442	76.0	30.3%	0	0.005	0.005	0.006	0
Classroom 35	16:01	460	75.5	31.8%	0	0.005	0.004	0.009	0
Portable 80/23	16:17	422	74.3	30.3%	0	0.005	0.005	0.007	0
Portable 81/24	16:19	603	76.8	29.7%	0	0.009	0.006	0.012	0
Outside 1 (ext rm 81)	16:33	400	68.8	29.2%	0	0.005	0.002	0.014	0
Outside 2	16:35	390	78.2	20.3%	0	0.008	0.005	0.020	0
Kitchen - Food Prep	17:15	460	75.3	26.7%	0	0.008	0.005	0.019	0
Boys Locker Room	17:18	445	75.1	23.3%	0	0.004	0.0012	0.004	0
Portable Rm 70	16:59	735	75.1	32.0%	0	0.006	0.0014	0.008	0
Portable Rm 71	17:05	700	74.2	26.7%	0	0.011	0.010	0.013	0
Portable Rm 60	16:46	410	78.1	22.9%	0	0.012	0.005	0.013	0
Portable Rm 61	16:51	435	75.3	26.8%	0	0.011	0.010	0.014	0
Outside 3	17:31	400	71.1	22.3%	0	0.010	0.002	0.011	0
Outside 4	17:38	415	72.8	23.4%	0	0.007	0.005	0.011	0

**Bolded values indicate the assessed parameter value fell outside of the range deemed acceptable**

Sampled/Assessed by: Lauren Tilley

*Lauren Tilley*

Print

Sign