

Equipment Floor Plan

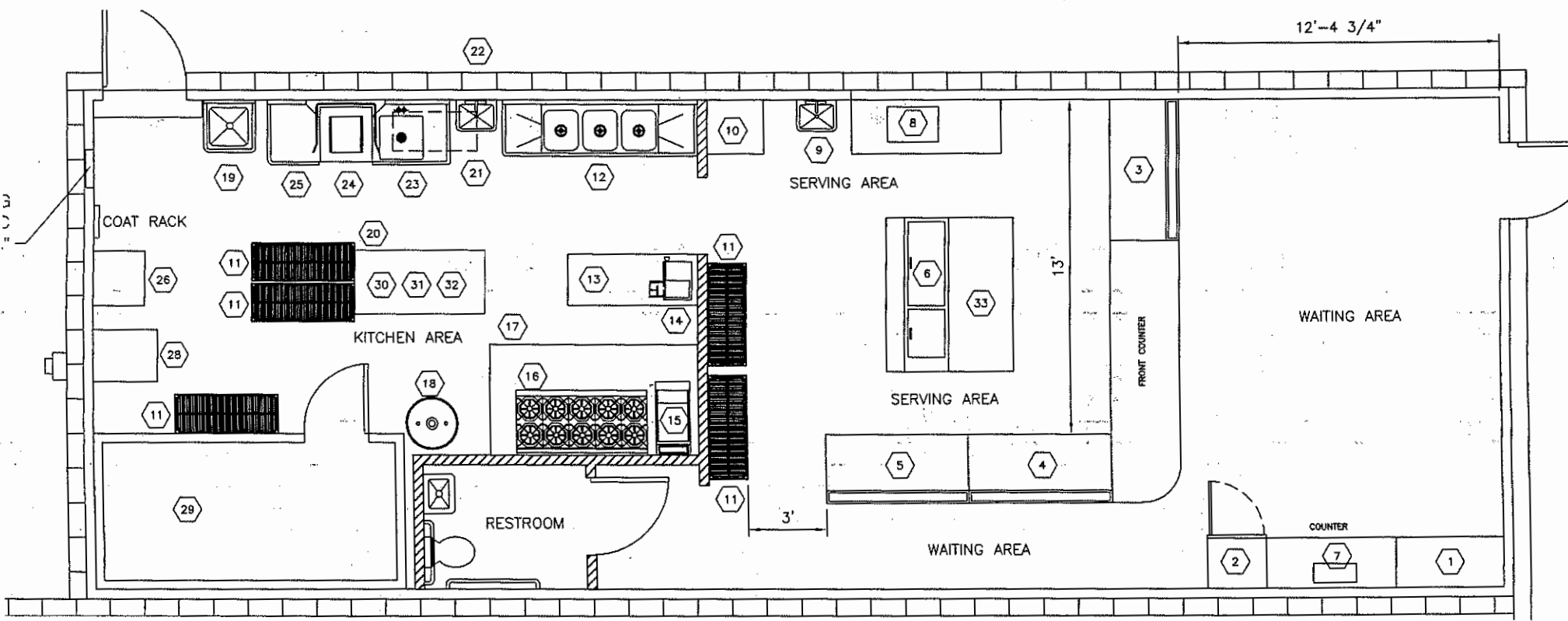

SAMPLE ONLY

EQUIPMENT LIST													
No.	Equipment		Qty	Model No.	Manufacturer	Overall Dimension			BTU Rating	HP	Phase	Volts	Amps
						Length	Wide	Height					
1	Open Display Merchandiser	new	1	C05978R	Structural Concepts	50"	30"	69"	-	-	-	-	-
2	Freezer Merchandiser	new	1	GDM-23F	True Food Service	27"	30"	70"	-	-	-	-	-
3	Pastry Display	new	1	RBG5984	Structural Concepts	60"	35"	36"	-	-	-	-	-
4	Deli Display Case (Refrigerator)	new	1	RBG5984	Structural Concepts	72"	35"	42"	-	1/3	1	115	7.6
5	Deli Display Case (Refrigerator)	exist	1	MDL-6S/C	Marc Refrigeration	72"	35"	42"	-	1/3	1	115	7.6
6	Sandwich Unit	exist	1	SP72-30M	Beverage Air	72"	30"	36"	-	1/5	1	115	6.0
7	Coffee Machine	exist	1	VPR	Bunn				-	-	-	-	-
8	Microwave	exist	1	R-21AC	Sharp				-	-	-	-	-
9	Hand Sink (drop-in)	exist	1		Eagle	14"	10"	5"	-	-	-	-	-
10	Ice Machine	exist	1	167-UCAS-161	Crystal Line	26"	25"	34"	-	-	-	-	-
11	Stainless Steel Shelf	exist	AR	S4-74-1848V	Eagle Group/Metal Masters	48"	18"	74"	-	-	-	-	-
12	3 Compartment Sink	new	1	3N1618-2D18	Universal Stainless	88"	23 1/2"	34"	-	-	-	-	-
13	Work Table	exist	1	T2472	Eagle	72"	24"	34"	-	-	-	-	-
14	Meat Slicer	exist	1	GC510	Globe				-	-	-	-	-
15	Deep Fryer	exist	1	SR42G	Dean	27 1/2"	15 1/2"	35 1/2"	90,000	-	-	-	-
16	Burner/Oven	new	1	S102626	Sunfire Series	60"	30"	34"	200,000	-	-	-	-
17	Exhaust Hood	new	1	Custom	Greenheck	96"	48"	24"	-	-	-	-	-
18	Water Heater	exist	1	50 Gallon	By Others	-	-	-	-	-	-	-	-
19	Mop Sink	exist	1			20"	24"		-	-	-	-	-
20	Work Table	new	1	T3060	Eagle Group/Metal Masters	30"	60"	34 1/4"	-	-	-	-	-
21	GRD	exist	1	50 gallon					-	-	-	-	-
22	Hand Sink	new	1	E3118	Universal Stainless	14 3/4"	18 7/8"	14 1/4"	-	-	-	-	-
23	Dishtable, Straight	exist	1	DTC-S60-36L	Advance Tabco	36"	30"	34 1/4"	-	-	-	-	-
24	Dish Washer	exist	1	BD4	Century	24"	30"	55"	-	-	-	-	-
25	Dishtable, Straight	exist	1	DTS-S60-36R	Advance Tabco	36"	30"	34 1/4"	-	-	-	-	-
26	Reach-In Freezer	exist	1	DL1F-SS-GD	Continental Refrigerator	27"	30"	70"	-	-	-	-	-
27	Convection Oven	delete							-	-	-	-	-
28	Proof Box	exist	1	200A136P01	EPCO				-	-	-	-	-
29	Walk-In Cooler	new	1	Custom	Amerikooler	72"	144"	74"	-	-	-	-	-
30	Food Blender	new	1	H101	Hamilton Beach	72"	144"	74"	-	-	-	-	-
31	Food Mixer	new	1	E2770	Hamilton Beach				-	-	-	-	-
32	Food Processor	new	1	1K5801	DON				-	-	-	-	-
33	Soda Dispenser/Counter	new	1	E2561	True Food Service				-	-	-	-	-

Specifications must also be submitted for all new equipment.

SAMPLE ONLY